



Angle-pad Coupling
GKS
P10



HDPE Coupling
HDPE
P10



Rigid Coupling
XGQT1
P11



Flexible Coupling
XGQT2
P12



Flexible Coupling (Heavy-duty)
M2
P13



Rigid Coupling (Heavy-duty)
M1
P13



Reducing Flexible Coupling
XGQT3
P14



90° Elbow
XGQT01
P15



Grooved 45° Elbow
XGQT011
P16



Grooved 22.5° Elbow
XGQT012
P17



Grooved 11.25° Elbow
XGQT013
P17



Grooved Tee
XGQT03
P18



Grooved Reducing Tee
XGQT03
P19



Bullhead Tee
XGQT03
P21



Threaded Reducing Tee
XGQT03S
P22



Grooved Cross
XGQT05
P24



Grooved Reducing Cross
XGQT05
P25



Threaded Reducing Cross
XGQT05S
P27



Grooved Mechanical Tee
XGQT04G
P29



Threaded Mechanical Tee
XGQT04
P31



Grooved Mechanical Cross
XGQT04G
P34



Threaded Mechanical Cross
XGQT04
P35



90° Reducing Elbow
XGQT014
P36



U-Bolt Mechanical Tee
041
P37



Small Threaded Mechanical Tee
L922
P37



Grooved Reducer
XGQT07
P38



Threaded Reducer
XGQT07S
P40



Grooved Eccentric Reducer
XGQT072
P44



Grooved Flange PN16
XGQT09
P42



Grooved Flange ANSI125/150
L991
P42



Flange Adaptor PN16
XGQT08
P43



Flange Adaptor ANSI125/150
L981
P43



Grooved Cap
XGQT06
P44



Cap with Eccentric hole
XGQT061
P45

TEST EQUIPMENT



Salt Spray Test

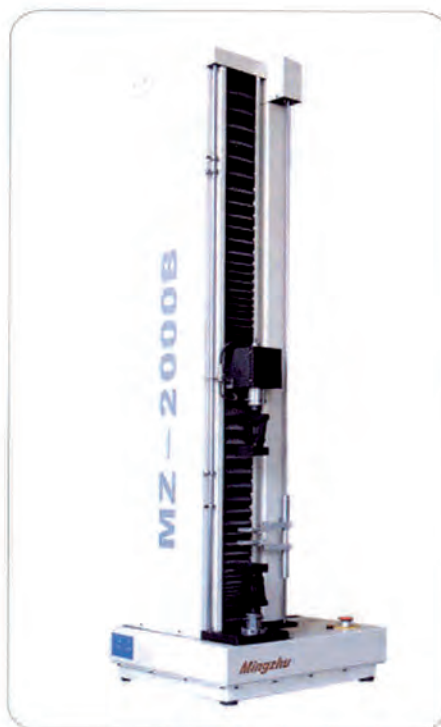

Gasket Test



Pressure Test



Air Test



Spectrom For Material

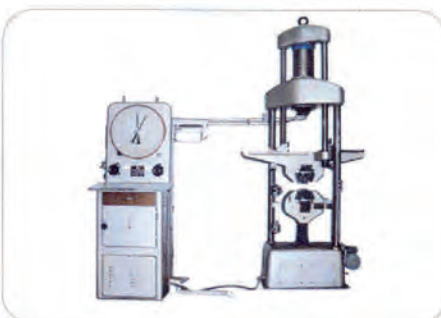

Strength Test

PRODUCTION EQUIPMENT

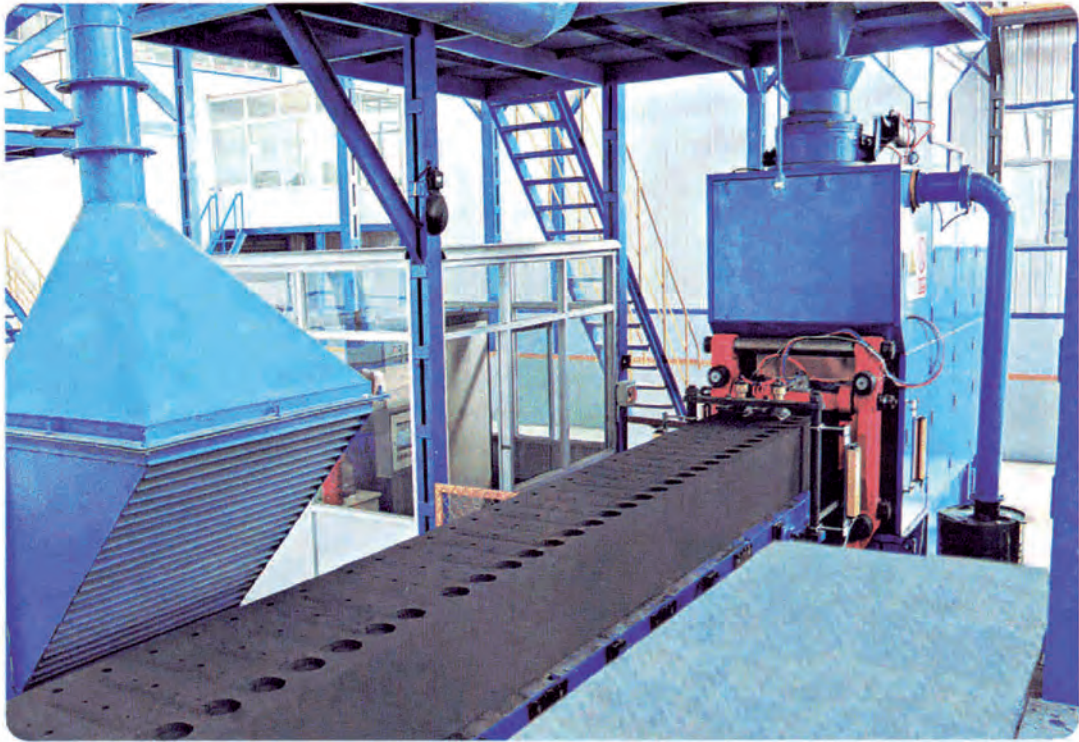

Casting Line



Electrophoretic Treatment



Machining Plant



Mold Center

TEST EQUIPMENT



Coating Line



Packing Line

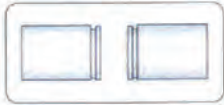

Grooved Pipe



Gasket



Lubricate the gasket



Slide another pipe end



Close another pipe end

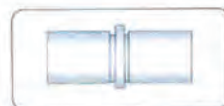

Slide another pipe end into the gasket

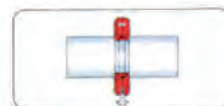

Place the housings over the gasket



Tighten the bolts and nuts

Pipe
Preparation

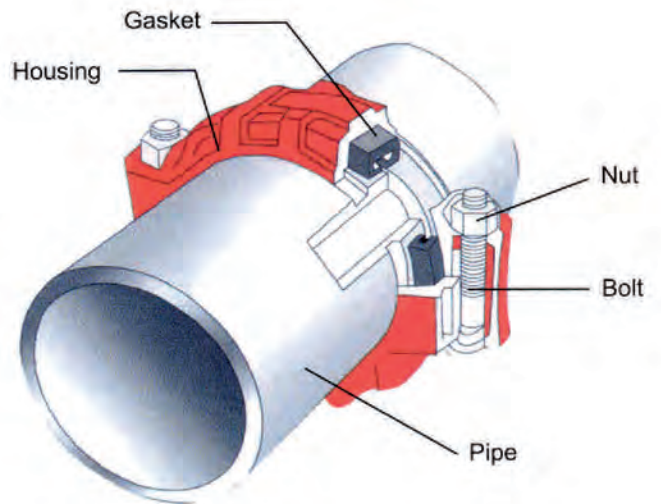

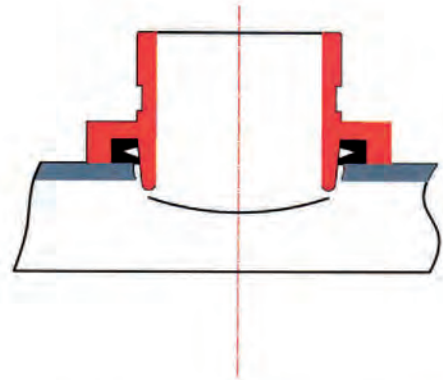

Nominal Diameter	O.D/in	O.D/mm	A1	B1	C1	C (mm)		T	F
						Basic Size	Tolerance		
mm	mm	mm	mm	mm	mm	Basic Size	Tolerance	mm	mm
DN25	1"	33.7	15.9	7.2	1.6	30.2	-0.38	1.8	34.5
DN32	1 1/4"	42.4	15.9	7.2	1.6	39	-0.38	1.8	43.3
DN40	1 1/2"	48.3	15.9	7.2	1.6	45.1	-0.38	1.8	49.4
DN50	2"	60.3	15.9	8.8	1.6	57.2	-0.38	1.8	62.2
DN65	2 1/2"	73	15.9	8.8	2	69.1	-0.46	2.3	75.2
DN65	2 1/2"	76.1	15.9	8.8	2	72.3	-0.46	2.3	77.7
DN80	3"	88.9	15.9	8.8	2	84.9	-0.46	2.3	90.6
DN100	4"	108	15.9	8.8	2.1	103.7	-0.51	2.3	109.7
DN100	4"	114.3	15.9	8.8	2.1	110.1	-0.51	2.3	116.2
DN125	5"	133	15.9	8.8	2.1	129.1	-0.51	2.9	134.9
DN125	5"	139.7	15.9	8.8	2.1	135.5	-0.51	2.9	141.7
DN125	5"	141.3	15.9	8.8	2.1	137	-0.56	2.9	143.5
DN150	6"	159	15.9	8.8	2.2	154.5	-0.56	2.9	161
DN150	6"	165.1	15.9	8.8	2.2	160.9	-0.56	2.9	167.1
DN150	6"	168.3	15.9	8.8	2.2	164	-0.56	2.9	170.7
DN200	8"	219.1	19.1	11.9	2.4	214.4	-0.64	2.9	221.5
DN250	10"	273	19.1	11.9	2.4	268.3	-0.69	3.6	275.4
DN300	12"	323.9	19.1	11.9	2.8	318.3	-0.76	4	326.2
DN350	14"	355.6	23.8	11.9	2.8	350	-0.7	4.5	359

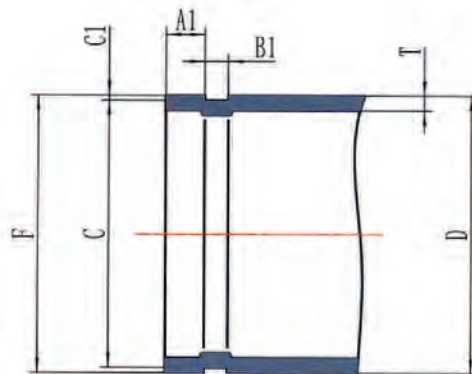

Extra degrees of deflection angular is allowed for flexible coupling, but when the flexible coupling is assembled, the value must be no more than the maximum degree.

Norminal Diameter	O.D/in	O.D/mm	Max Deflection Angular
DN25	1"	33.7	2.3
DN32	1¼"	42.4	2.3
DN40	1½"	48.3	2.3
DN50	2"	60.3	2.3
DN65	2½"	73	1.9
DN65	2½"	76.1	1.9
DN80	3"	88.9	1.6
DN100	4"	108	1.7
DN100	4"	114.3	1.6
DN125	5"	133	1.4
DN125	5"	139.7	1.3
DN125	5"	141.3	1.3
DN150	6"	159	1.2
DN150	6"	165.1	1.1
DN150	6"	168.3	1.1
DN200	8"	219.1	0.8
DN250	10"	273	0.7
DN300	12"	323.9	0.6
DN350	14"	355.6	0.5

To ensure valid seal property, the torque of the bolts must be within the scope of the demands, Too big torque will damage the bolts and housing, too small torque will cause leakage.

Bolt	Torque(N*M)
M8(5/16)	25-30
M10(3/8)	60-70
M12(1/2)	90-100
M14(9/16)	135-150
M16(5/8)	200-230
M20(3/4)	270-300
M22(7/8)	270-300

Angle-pad Coupling GKS

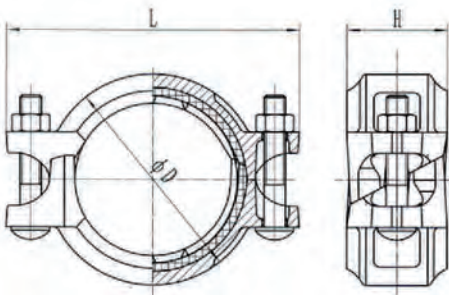

Nominal Size mm/in	Pipe O.D mm/in	Dimensions			Bolt inch/mm	Working pressure Psi
		ΦD mm	L mm	H mm		
25	33.7	56	96	47	3/8×2-3/8 (M10×60)	300
1	1.327					
32	42.4					
1 1/4	1.669					
40	48.3	64	106	47		
1 1/2	1.9					
50	60.3	69	113	47		
2	2.375					
65	73	88	122	47		
2 1/2	2.875					
65	76.1	100	137	47		
2 1/2	3					
80	88.9	100	137	47		
3	3.5					
100	114.3	116	154	47		
4	4.5					
125	139.7	142	188	52		
5	5.5					
125	141.3	170	219	52		
5	5.563					
150	159	170	219	52		
6	6.25					
150	165.1	196	244	52		
6	6.5					
150	168.3	197	244	52		
6	6.625					
200	219.1	262	322	66		
8	8.625					
250	273	325	400	66		
10	10.75					
300	323.9	376	468	67		
12	12.75					

HDPE Coupling HDPE

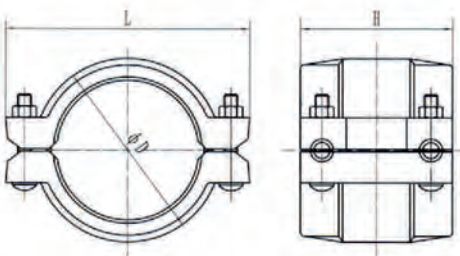

Nominal Size mm/in	Pipe O.D mm/in	Dimensions			Bolt/Nut Size (mm)
		ΦD mm	L mm	H mm	
50	63	85	128	105	3/8×2-1/8 (M10×55)
2	2.5				
80	90	110	169	105	1/2×3 (M12×75)
3	3.5				
100	110	138	181	113	1/2×3 (M12×75)
4	4.3				
150	160	190	261	147	5/8×3-1/2 (M16×90)
6	6.3				
200	200	233	319	154	5/8×3-1/2 (M16×90)
8	7.9				
250	250	287	351	136	5/8×4-3/4 (M16×120)
10	9.8				
300	315	351	442	136	3/4×4-3/4 (M20×120)
12	12.4				

Nominal Size mm/in	Pipe O.D mm/in	Dimensions			Bolt inch/mm	Working pressure Psi
		ΦD mm	L mm	H mm		
25	33.7	55	97	45	3/8×1-1/2 (M10×40)	300
1	1.327					
32	42.4	63.5	107.5	45	3/8×1-3/4 (M10×45)	
1 1/4	1.669					
40	48.3	69	114	45	3/8×2-1/8 (M10×55)	
1 1/2	1.9					
50	57	83.6	124	46	3/8×2-1/8 (M10×55)	
2	2.244					
50	60.3	83.6	124	46	3/8×2-1/8 (M10×55)	
2	2.375					
65	73	98	137	46	3/8×2-1/8 (M10×55)	
2 1/2	2.875					
65	76.1	98	139	46	3/8×2-1/8 (M10×55)	
2 1/2	3					
80	88.9	114	156	46	1/2×2-5/8 (M12×65)	
3	3.5					
100	108	138	186	50	1/2×2-5/8 (M12×65)	
4	4.25					
100	114.3	142	189	50	1/2×2-5/8 (M12×65)	
4	4.5					
125	133	164	213	50	1/2×2-5/8 (M12×65)	
5	5.25					
125	139.7	170	222	50	1/2×2-5/8 (M12×65)	
5	5.5					
125	141.3	170	218	50	1/2×2-5/8 (M12×65)	
5	5.563					
150	159	192	244	50	1/2×2-5/8 (M12×65)	
6	6.25					
150	165.1	196	244	50	1/2×2-5/8 (M12×65)	
6	6.5					
150	168.3	198	251	50	1/2×2-5/8 (M12×65)	
6	6.625					
200	216.3	254	340	62	3/4×3-1/2 (M20×90)	
8	8.515					
200	219.1	256	316	58	5/8×3-1/8 (M16×80)	
8	8.625					
250	267.4	313	400	64	3/4×3-1/2 (M20×90)	
10	10.527					
250	273	319	393	64	3/4×3-1/2 (M20×90)	
10	10.75					
300	318.5	368	464	64	7/8×4-1/3 (M22×110)	
12	12.539					
300	323.9	374	453	65	3/4×4-1/3 (M20×110)	
12	12.75					

Rigid Coupling XGQT1

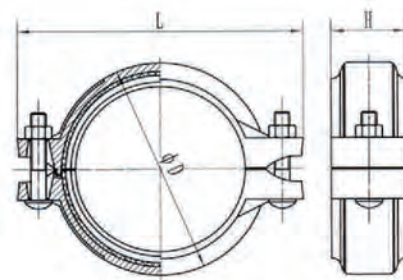

Flexible Coupling XGQT2

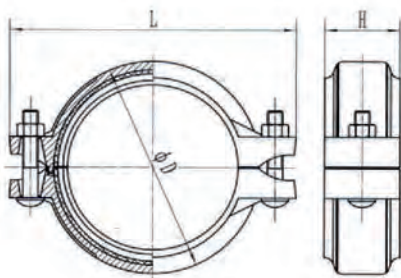

Nominal Size mm/in	Pipe O.D mm/in	Dimensions			Bolt inch/mm	Working pressure Psi
		ΦD mm	L mm	H mm		
25	33.7	55	97	45	3/8×1-1/2 (M10×40)	300
1	1.327					
32	42.4					
1 1/4	1.669	63.5	107.5	45	3/8×1-3/4 (M10×45)	
40	48.3					
1 1/2	1.9	69	114	45		
50	57					
2	2.244	83.6	124	46		
50	60.3					
2	2.375	83.6	124	46		
65	73					
2 1/2	2.875	98	137	46	3/8×2-1/8 (M10×55)	
65	76.1					
2 1/2	3	98	139	46		
80	88.9					
3	3.5	114	156	46		
100	108					
4	4.25	138	186	50		
100	114.3					
4	4.5	142	189	50		
125	133					
5	5.25	164	213	50		
125	139.7					
5	5.5	170	222	50		
125	141.3					
5	5.563	170	218	50	1/2×2-5/8 (M12×65)	
150	159					
6	6.25	192	244	50		
150	165.1					
6	6.5	196	244	50		
150	168.3					
6	6.625	198	251	50		
200	216.3					
8	8.515	254	340	62	3/4×3-1/2 (M20×90)	
200	219.1					
8	8.625	256	316	58	5/8×3-1/8 (M16×80)	
250	267.4					
10	10.527	313	400	64	3/4×3-1/2 (M20×90)	
250	273.0					
10	10.75	319	393	64	3/4×3-1/2 (M20×90)	
300	318.5					
12	12.539	368	464	64	7/8×4-1/3 (M22×110)	
300	323.9					
12	12.75	374	453	65	3/4×4-1/3 (M20×110)	
350	355.6					
14	14	410	510	75	7/8×4-1/3 (M22×110)	
350	377					
14	14.843	428	478.4	75	7/8×3-1/2 (M22×90)	
400	426					
16	16.771	478	528.6	75		

Nominal Size mm/in	Pipe O.D mm/in	Dimensions			Bolt inch/mm	Working pressure Psi
		ΦD mm/inch	L mm/inch	H mm/inch		
32	42.2	68	117	45	3/8×2 (M10×50)	500
1 1/4	1.66	2.68	4.61	1.77		
40	48.3	74	122	45		
1 1/2	1.9	2.91	4.82	1.77		
50	60.3	87	133	48		
2	2.375	3.43	5.22	1.88		
65	73	98	144	48		
2 1/2	2.875	3.88	5.68	1.88		
80	88.9	114	178	48	1/2×2-3/4 (M12×70)	450
3	3.5	4.5	7	1.88		
100	114.3	147	204	54		
4	4.5	5.8	8.03	2.13		
125	141.3	175	256	54	5/8×3-1/4 (M16×85)	450
5	5.563	6.88	10.07	2.13		
150	168.3	203	281	54		
6	6.625	8	11.07	2.13		
200	219.1	263	355	59	3/4×4-1/4 (M20×110)	450
8	8.625	10.34	13.97	2.13		

Flexible Coupling (Heavy-duty) M2

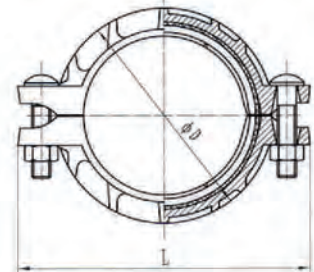
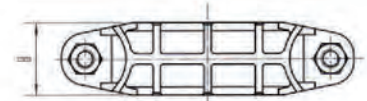

Nominal Size mm/in	Pipe O.D mm/in	Dimensions			Bolt inch/mm	Working pressure Psi
		ΦD mm/inch	L mm/inch	H mm/inch		
32	42.2	68	117	45	3/8×2 (M10×50)	500
1 1/4	1.66	2.68	4.61	1.77		
40	48.3	74	122	45		
1 1/2	1.9	2.91	4.82	1.77		
50	60.3	87	133	48		
2	2.375	3.43	5.22	1.88		
65	73	98	144	48		
2 1/2	2.875	3.88	5.68	1.88		
80	88.9	114	178	48	1/2×2-3/4 (M12×70)	450
3	3.5	4.5	7	1.88		
100	114.3	147	204	54		
4	4.5	5.8	8.03	2.13		
125	141.3	175	256	54	5/8×3-1/4 (M16×85)	450
5	5.563	6.88	10.07	2.13		
150	168.3	203	281	54		
6	6.625	8	11.07	2.13		
200	219.1	263	355	59	3/4×4-1/4 (M20×110)	450
8	8.625	10.34	13.97	2.13		

Rigid Coupling (Heavy-duty) M1

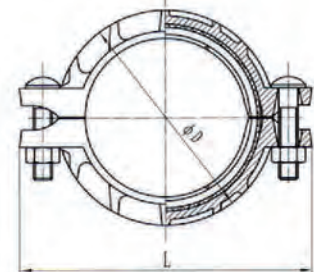

Reducing Flexible Coupling XGQT3

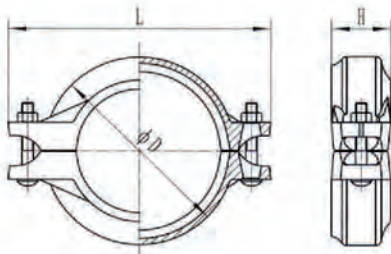

Nominal Size mm/in	Pipe O.D mm/in	Dimensions			Bolt inch/mm	Working pressure Psi
		ΦD mm	L mm	H mm		
50×40	60.3×48.3	82	130	46	3/8×2-1/8 (M10×55)	300
2×1½	2.375×1.9					
65×25	73×33.7					
2½×1	2.875×1.327	97	151	46		
65×32	73×42.4					
2½×1¼	2.875×1.669	97	151	46		
65×40	73×48.3					
2½×1½	2.875×1.9	97	151	46		
65×50	73×60.3					
2½×2	2.875×2.375	107	151	46		
65×50	76.1×60.3					
2½×2	3×2.375	112	166.6	46		
80×40	88.9×48.3					
3×1½	3.5×1.9	123.6	166.6	46		
80×50	88.9×60.3					
3×2	3.5×2.375	123.6	166.6	46		
80×65	88.9×73.0					
3×2½	3.5×2.875	123.6	166.6	46		
80×65	88.9×76.1					
3×2½	3.5×3	151.2	200	50		
100×50	114.3×60.3					
4×2	4.5×2.375	151.2	200	50		
100×65	114.3×73.0					
4×2½	4.5×2.875	151.2	200	50		
100×65	114.3×76.1					
4×2½	4.5×3.0	151.2	200	50		
100×80	114.3×88.9					
4×3	4.5×3.5	167	230	52		
125×100	141.3×114.3					
5×4	5.563×4.5	197	275	52		
150×80	165.1×88.9					
6×3	6.5×3.5	197	275	52		
150×100	165.1×114.3					
6×4	6.5×4.5	199.4	275	52		
150×65	168.3×73					
6×2½	6.525×2.875	199.4	275	52		
150×80	168.3×88.9					
6×3	6.525×3.5	199.4	275	52		
150×100	168.3×114.3					
6×4	6.525×4.5	199.4	275	52		
150×100	168.3×141.3					
6×5	6.625×5.563	258	336	58		
200×150	219.1×168.3					
8×6	8.625×6.525				3/4×4-1/3 (M20×110)	

Nominal Size mm/in	Pipe O.D mm/in	Dimensions	Working Pressure (psi)
		L (mm)	
50	60.3	70	300
2	2.375		
65	73	76	
2 1/2	2.875		
65	76.1	76	
2 1/2	3		
80	88.9	85	
3	3.5		
100	108	102	
4	4.25		
100	114.3	102	
4	4.5		
125	133	121	
5	5.25		
125	139.7	121	
5	5.5		
125	141.3	121	
5	5.563		
150	159	130	
6	6.25		
150	165.1	130	
6	6.5		
150	168.3	140	
6	6.625		
200	219.1	175	
8	8.625		
250	273	215	
10	10.75		
300	323.9	220	
12	12.75		

Nominal Size mm/in	Pipe O.D mm/in	Dimensions	Working Pressure (psi)
		L (mm)	
25	33.7	57	300
1	1.327		
32	42.4	70	
1 1/4	1.669		
40	48.3	70	
1 1/2	1.9		
50	60.3	83	
2	2.375		
65	73	95	
2 1/2	2.875		
65	76.1	95	
2 1/2	3		
80	88.9	108	
3	3.5		
100	114.3	127	
4	4.5		
125	139.7	140	
5	5.5		
125	141.3	140	
5	5.563		
150	159	165	
6	6.25		
150	165.1	165	
6	6.5		
150	168.3	165	
6	6.625		
200	219.1	197	
8	8.625		

Grooved 90° Elbow Short XGQT01

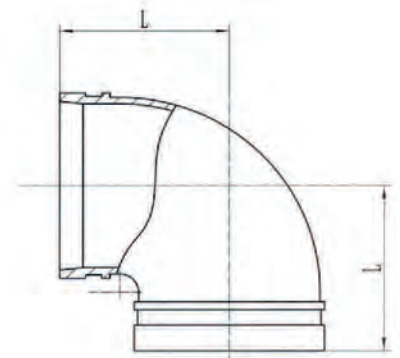

Grooved 90° Elbow Standard XGQT01

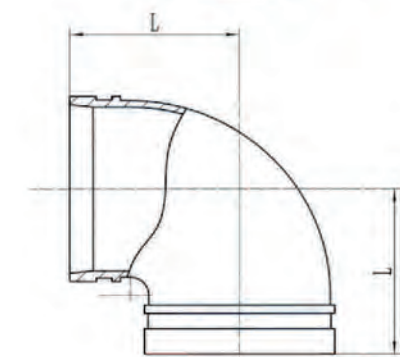

**Grooved 45° Elbow Short
XGQT011**

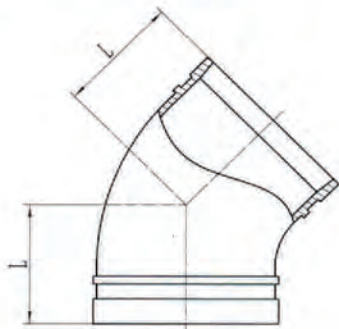

**Grooved 45° Elbow Standard
XGQT011**

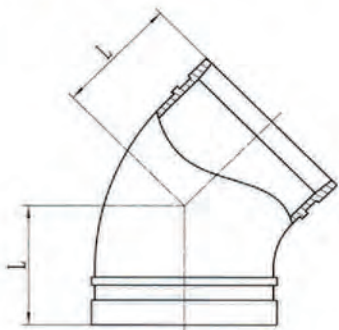

Nominal Size mm/in	Pipe O.D mm/in	Dimensions	Working Pressure (psi)
		L (mm)	
65	76.1	48	300
21/2	3		
80	88.9	53	
3	3.5		
100	108	60	
4	4.25		
100	114.3	60	
4	4.5		
125	133	68	
5	5.25		
125	139.7	68	
5	5.5		
125	141.3	68	
5	5.563		
150	159	75.5	
6	6.25		
150	165.1	75.5	
6	6.5		
150	168.3	75.5	
6	6.625		
200	219.1	95	
8	8.625		
250	273	112	
10	10.75		
300	323.9	135	
12	12.75		

Nominal Size mm/in	Pipe O.D mm/in	Dimensions	Working Pressure (psi)
		L (mm)	
25	33.7	45	300
1	1.327		
32	42.4	45	
1 1/4	1.669		
40	48.3	45	
1 1/2	1.9		
50	60.3	51	
2	2.375		
65	73	62	
2 1/2	2.875		
65	76.1	62	
2 1/2	3		
80	88.9	70	
3	3.5		
100	108	76	
4	4.25		
100	114.3	76	
4	4.5		
125	133	83	
5	5.25		
125	139.7	83	
5	5.5		
125	141.3	83	
5	5.563		
150	159	89	
6	6.25		
150	165.1	89	
6	6.5		
150	168.3	89	
6	6.625		
200	219.1	108	
8	8.625		

Nominal Size mm/in	Pipe O.D mm/in	Dimensions	Working pressure (Psi)
		L (mm)	
50	60.3	48	300
2	2.375		
65	73	51	
2 1/2	2.875		
65	76.1	51	
2 1/2	3		
80	88.9	57	
3	3.5		
100	108	73	
4	4.25		
100	114.3	73	
4	4.5		
125	133	73	
5	5.25		
125	139.7	73	
5	5.5		
125	141.3	73	
5	5.563		
150	159	79	
6	6.25		
150	165.1	79	
6	6.5		
150	168.3	79	
6	6.625		
200	219.1	98	
8	8.625		

Grooved 22.5° Elbow XGQT012

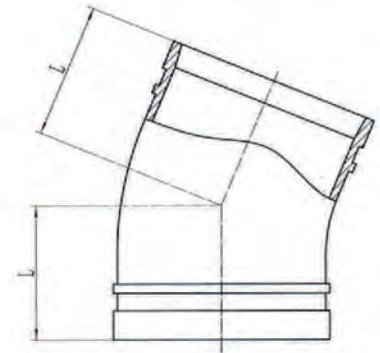

Nominal Size mm/in	Pipe O.D mm/in	Dimensions	Working pressure (Psi)
		L (mm)	
50	60.3	35	300
2	2.375		
65	73	38	
2 1/2	2.875		
65	76.1	38	
2 1/2	3		
80	88.9	38	
3	3.5		
100	108	45	
4	4.25		
100	114.3	45	
4	4.5		
125	133	51	
5	5.25		
125	139.7	51	
5	5.5		
125	141.3	51	
5	5.563		
150	159	51	
6	6.25		
150	165.1	51	
6	6.5		
150	168.3	51	
6	6.625		
200	219.1	51	
8	8.625		

Grooved 11.25° Elbow XGQT013

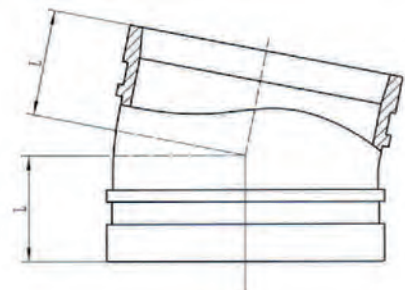

Grooved Tee Short XGQT03

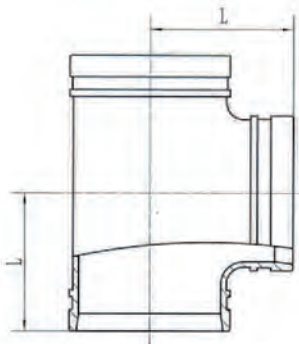

Nominal Size mm/in	Pipe O.D mm/in	Dimensions	Working Pressure (psi)
		L (mm)	
50	60.3	70	300
2	2.375		
65	73	76	
2 1/2	2.875		
65	76.1	76	
2 1/2	3		
80	88.9	85	
3	3.5		
100	108	102	
4	4.25		
100	114.3	102	
4	4.5		
125	133	121	
5	5.25		
125	139.7	121	
5	5.5		
125	141.3	121	
5	5.563		
150	159	130	
6	6.25		
150	165.1	130	
6	6.5		
150	168.3	140	
6	6.625		
200	219.1	175	
8	8.625		
250	273	215	
10	10.75		
300	323.9	220	
12	12.75		

Grooved Tee Standard XGQT03

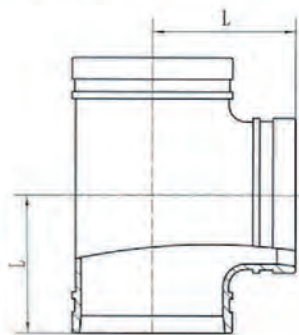

Nominal Size mm/in	Pipe O.D mm/in	Dimensions	Working Pressure (psi)
		L (mm)	
25	33.7	57	300
1	1.327	70	
32	42.4		
1 1/4	1.669	70	
40	48.3		
1 1/2	1.9	84	
50	60.3		
2	2.375	95	
65	73		
2 1/2	2.875	95	
65	76.1		
2 1/2	3	108	
80	88.9		
3	3.5	127	
100	114.3		
4	4.5	140	
125	139.7		
5	5.5	140	
125	141.3		
5	5.563	165	
150	159		
6	6.25	165	
150	165.1		
6	6.5	165	
150	168.3		
6	6.625	197	
200	219.1		
8	8.625		

Nominal Size mm/in	Pipe O.D mm/in	Dimensions				Working pressure (Psi)	
		L (mm)			D		d
		L SHORT	L1	L SHORT (+)	mm		mm
50x32	60.3x42.4			70	60	42	
2x1¼	2.375x1.669						
50x40	60.3x48.3			70	60	48	
2x1½	2.375x1.9						
65x32	73x42.4			76	73	42	
2½x1¼	2.875x1.669						
65x40	73x48.3			76	73	48	
2½x1½	2.875x1.9						
65x50	73x60.3			76	73	60	
2½x2	2.875x2.375						
65x32	76.1x42.4			76	76	42	
2½x1¼	3x1.669						
65x40	76.1x48.3			76	76	48	
2½x1½	3x1.9						
65x50	76.1x60.3			76	76	60	
2½x2	3x2.375						
80x32	88.9x42.4			86	89	42	
3x1¼	3.5x1.669						
80x40	88.9x48.3			86	89	48	
3x1½	3.5x1.9						
80x50	88.9x60.3			86	89	60	
3x2	3.5x2.375						
80x65	88.9x73			86	89	73	
3x2½	3.5x2.875						
80x65	88.9x76.1			86	89	76	
3x2½	3.5x3						
100x50	108x60.3	90	98	102	108	60	
4x2	4.25x2.375						
100x65	108x73	90	98	102	108	73	
4x2½	4.25x2.875						
100x65	108x76.1	90	98	102	108	76	
4x2½	4.25x3						
100x80	108x88.9	90	98	102	108	89	
4x3	4.25x3.5						
100x32	114.3x42.4	90	98	102	114	42	
4x1¼	4.5x1.669						
100x40	114.3x48.3	90	98	102	114	48	
4x1½	4.5x1.9						
100x50	114.3x60.3	90	98	102	114	60	
4x2	4.5x2.375						
100x65	114.3x73	90	98	102	114	73	
4x2½	4.5x2.875						
100x65	114.3x76.1	90	98	102	114	76	
4x2½	4.5x3						
100x80	114.3x88.9	90	98	102	114	89	
4x3	4.5x3.5						
125x65	133x76.1		105	121	133	76	
5x2½	5.25x3						
125x80	133x88.9		105	121	133	89	
5x3	5.25x3.5						
125x100	133x108		105	121	133	108	
5x4	5.25x4.25						
125x100	133x114.3		105	121	133	114	
5x4	5.25x4.5						
125x50	139.7x60.3		105	121	140	60	
5x2	5.5x2.375						
125x65	139.7x76.1		105	121	140	76	
5x2½	5.5x3						
125x80	139.7x88.9		105	121	140	89	
5x3	5.5x3.5						
125x100	139.7x108		105	121	140	108	
5x4	5.5x4.25						

Grooved Reducing Tee XGQT03

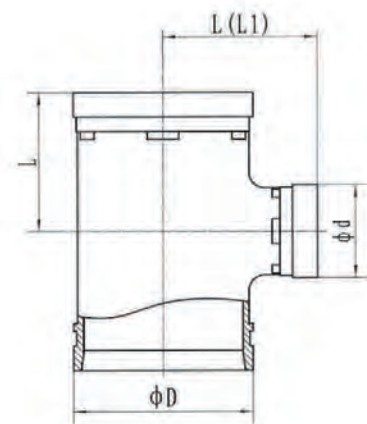

300

Grooved Reducing Tee XGQT03

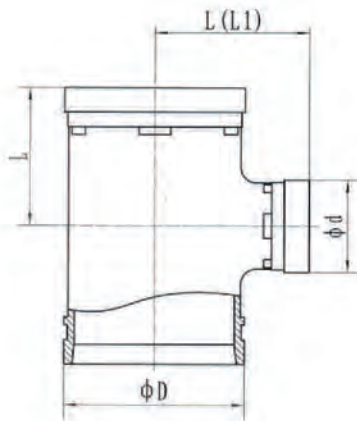

Nominal Size mm/in	Pipe O.D mm/in	Dimensions				Working pressure (Psi)
		L (mm)		D mm	d mm	
		SHORT	L1 SHORT (+)			
125×100	139.7×114.3					300
5×4	5.5×4.5	105	121	140	114	
125×125	139.7×133					
5×5	5.5×5.25	105	121	140	133	
125×50	141.3×60.3					
5×2	5.563×2.375	105	121	141	60	
125×65	141.3×73					
5×2½	5.563×2.875	105	121	141	73	
125×80	141.3×88.9					
5×3	5.563×3.5	105	121	141	89	
125×100	141.3×114.3					
5×4	5.563×4.5	105	121	141	114	
150×65	159×76.1	110	120	130	76	
6×2½	6.25×3					
150×80	159×88.9	110	120	130	89	
6×3	6.25×3.5					
150×100	159×108	110	120	130	108	
6×4	6.25×4.25					
150×100	159×114.3	110	120	130	114	
6×4	6.25×4.5					
150×125	159×133	110	120	130	133	
6×5	6.25×5.25					
150×125	159×139.7	110	120	130	140	
6×5	6.25×5.5					
150×50	165.1×60.3	110	120	130	60	
6×2	6.5×2.375					
150×65	165.1×76.1	110	120	130	76	
6×2½	6.5×3					
150×80	165.1×88.9	110	120	130	89	
6×3	6.5×3.5					
150×100	165.1×108	110	120	130	108	
6×4	6.5×4.25					
150×100	165.1×114.3	110	120	130	114	
6×4	6.5×4.5					
150×125	165.1×133	110	120	130	133	
6×5	6.5×5.25					
150×125	165.1×139.7	110	120	130	140	
6×5	6.5×5.5					
150×50	168.3×60.3	110	120	140	60	
6×2	6.625×2.375					
150×65	168.3×76.1	110	120	140	76	
6×2½	6.625×3					
150×80	168.3×88.9	110	120	140	89	
6×3	6.625×3.5					
150×100	168.3×108	110	120	140	108	
6×4	6.625×4.25					
150×100	168.3×114.3	110	120	140	114	
6×4	6.625×4.5					
150×125	168.3×133	110	120	140	133	
6×5	6.625×5.25					
150×125	168.3×139.7	110	120	140	140	
6×5	6.625×5.5					
200×65	219.1×76.1					
8×2½	8.625×3	146	174	219	76	
200×80	219.1×88.9					
8×3	8.625×3.5	146	174	219	89	
200×100	219.1×108					
8×4	8.625×4.25	146	174	219	108	
200×100	219.1×114.3					
8×4	8.625×4.5	146	174	219	114	
200×125	219.1×133					
8×5	8.625×5.25	146	174	219	133	

Nominal Size mm/in	Pipe O.D mm/in	Dimensions				Working pressure (Psi)
		L (mm)		D mm	d mm	
		L SHORT	L1 SHORT (+)			
200×125 8×5	219.1×139.7 8.625×5.5	146	174	219	140	300
200×150 8×6	219.1×159 8.625×6.25	146	174	219	159	
200×150 8×6	219.1×165.1 8.625×6.5	146	174	219	165	
250×80 10×3	273×88.9 10.75×3.5	190		273	89	
250×100 10×4	273×108 10.75×4.25	190		273	108	
250×100 10×4	273×114.3 10.75×4.5	190		273	114	
250×125 10×5	273×133 10.75×5.25	190		273	133	
250×125 10×5	273×139.7 10.75×5.5	190		273	140	
250×125 10×5	273×141.3 10.75×5.563	190		273	141	
250×150 10×6	273×159 10.75×6.25	190		273	159	
250×150 10×6	273×165.1 10.75×6.5	190		273	165	
250×150 10×6	273×168.3 10.75×6.625	190		273	168	
250×200 10×8	273×219.1 10.75×8.625	190		273	219	
300×150 12×6	323.9×159 12.75×6.25	220		325	159	
300×150 12×6	323.9×165.1 12.75×6.5	220		325	165	
300×150 12×6	323.9×168.3 12.75×6.625	220		325	168	
300×200 12×8	323.9×219.1 12.75×8.625	220		325	219	
300×250 12×10	323.9×273 12.75×10.75	220		325	273	

Nominal Size mm/in	Pipe O.D mm/in	Dimensions				Working Pressure (psi)
		L (mm)		D mm	d mm	
80×100 3×4	88.9×114.3 3.5×4.5	115	125	89	114	2.5MPa (300PSI)
100×150 4×6	114.3×165.1 4.5×6.5	140		114	165	

Grooved Reducing Tee XGQT03

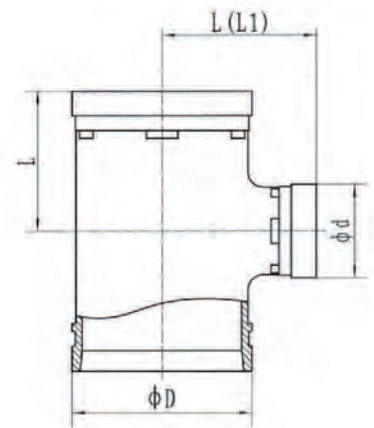

Bullhead Tee XGQT03

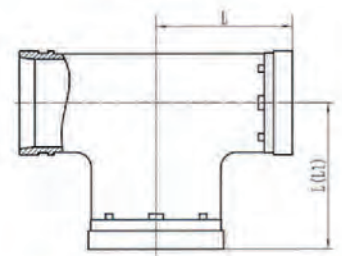

Threaded Reducing Tee XGQT03S

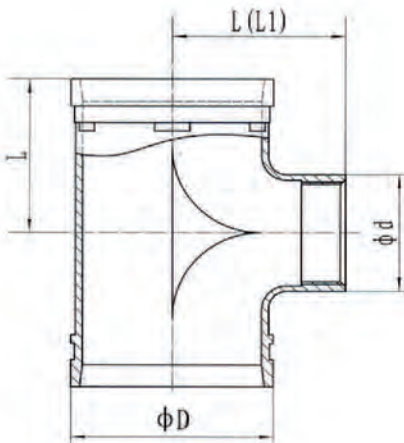

Nominal Size mm/in	Pipe O.D mm/in	Dimensions			Working pressure Psi	
		L (mm)		D		d
		L	L1	mm		mm
50×25	60.3×33.7	70		60	43	300
2×1	2.375×1.327	70		60	52	
50×32	60.3×42.4	70		60	58	
2×1¼	2.375×1.669	70		60	43	
50×40	60.3×48.3	76		73	52	
2×1½	2.375×1.9	76		73	58	
65×25	73.0×33.7	76		73	70	
2½×1	2.875×1.327	76		73	43	
65×32	73.0×42.4	76		73	52	
2½×1¼	2.875×1.669	76		73	58	
65×40	73.0×48.3	76		73	70	
2½×1½	2.875×1.9	76		76	43	
65×50	73.0×60.3	76		76	52	
2½×2	2.875×2.375	76		76	58	
65×25	76.1×33.7	86		89	43	
2½×1	3×1.327	86		89	52	
65×32	76.1×42.4	86		89	56	
2½×1¼	3×1.669	86		89	70	
65×40	76.1×48.3	86		89	86	
2½×1½	3×1.9	86		89	58	
65×50	76.1×60.3	86		89	70	
2½×2	3×2.375	86		89	86	
80×25	88.9×33.7	90		98	58	
3×1	3.5×1.327	90		98	70	
80×32	88.9×42.4	90		98	86	
3×1¼	3.5×1.669	90		98	99	
80×40	88.9×48.3	90		98	43	
3×1½	3.5×1.9	90		98	52	
80×50	88.9×60.3	90		98	58	
3×2	3.5×2.375	90		98	70	
80×65	88.9×76.1	90		98	86	
3×2½	3.5×3	90		98	99	
100×40	108.0×48.3	105		133	70	
4×1½	4.25×1.9	105		133	86	
100×50	108.0×60.3	105		133	99	
4×2	4.25×2.375	105		133	43	
100×65	108.0×76.1	105		133	52	
4×2½	4.25×3	105		133	58	
100×80	108×88.9	105		133	70	
4×3	4.25×3.5	105		133	86	
100×25	114.3×33.7	105		133	99	
4×1	4.5×1.327	105		133	43	
100×32	114.3×42.4	105		133	52	
4×1¼	4.5×1.669	105		133	58	
100×40	114.3×48.3	105		133	70	
4×1½	4.5×1.9	105		133	86	
100×50	114.3×60.3	105		133	99	
4×2	4.5×2.375	105		133	43	
100×65	114.3×76.1	105		133	52	
4×2½	4.5×3	105		133	58	
100×80	114.3×88.9	105		133	70	
4×3	4.5×3.5	105		133	86	
125×50	133.0×60.3	105		140	99	
5×2	5.25×2.375	105		140	43	
125×65	133.0×76.1	105		140	52	
5×2½	5.25×3	105		140	58	
125×80	133.0×88.9	105		140	70	
5×3	5.25×3.5	105		140	86	
125×100	133.0×114.3	105		140	99	
5×4	5.25×4.5	105		140	43	
125×40	139.7×48.3	105		140	52	
5×1½	5.5×1.9	105		140	58	

Nominal Size mm/in	Pipe O.D mm/in	Dimensions				Working pressure Psi
		L (mm)		D	d	
		L	L1	mm	mm	
125×50	139.7×60.3	105		140	70	300
5×2	5.5×2.375					
125×65	139.7×76.1	105		140	86	
5×2½	5.5×3					
125×80	139.7×88.9	105		140	99	
5×3	5.5×3.5					
125×100	139.7×114.3	105		140	124	
5×4	5.5×4.5					
125×40	141.3×48.3	105		141	58	
5×1½	5.563×1.9					
125×50	141.3×60.3	105		141	70	
5×2	5.563×2.375					
125×65	141.3×76.1	105		141	86	
5×2½	5.563×3					
125×80	141.3×88.9	105		141	99	
5×3	5.563×3.5					
125×100	141.3×114.3	105		141	124	
5×4	5.563×4.5					
150×40	159.0×48.3	110	120	159	58	
6×1½	6.25×1.9					
150×50	159.0×60.3	110	120	159	70	
6×2	6.25×2.375					
150×65	159.0×76.1	110	120	159	86	
6×2½	6.25×3					
150×80	159.0×88.9	110	120	159	99	
6×3	6.25×3.5					
150×100	159.0×114.3	110	120	159	124	
6×4	6.25×4.5					
150×40	165.1×48.3	110	120	165	58	
6×1½	6.5×1.9					
150×50	165.1×60.3	110	120	165	70	
6×2	6.5×2.375					
150×65	165.1×76.1	110	120	165	86	
6×2½	6.5×3					
150×80	165.1×88.9	110	120	165	99	
6×3	6.5×3.5					
150×100	165.1×114.3	110	120	165	124	
6×4	6.5×4.5					
150×40	168.3×48.3	110	120	168	58	
6×1½	6.625×1.9					
150×50	168.3×60.3	110	120	168	70	
6×2	6.625×2.375					
150×65	168.3×76.1	110	120	168	86	
6×2½	6.625×3					
150×80	168.3×88.9	110	120	168	99	
6×3	6.625×3.5					
150×100	168.3×114.3	110	120	168	124	
6×4	6.625×4.5					
200×50	219.1×60.3	146		219	70	
8×2	8.625×2.375					
200×50	219.1×76.1	146		219	86	
8×2½	8.625×3					
200×80	219.1×88.9	146		219	99	
8×3	8.625×3.5					
200×100	219.1×114.3	146		219	124	
8×4	8.625×4.5					

Threaded Reducing Tee XGQT03S

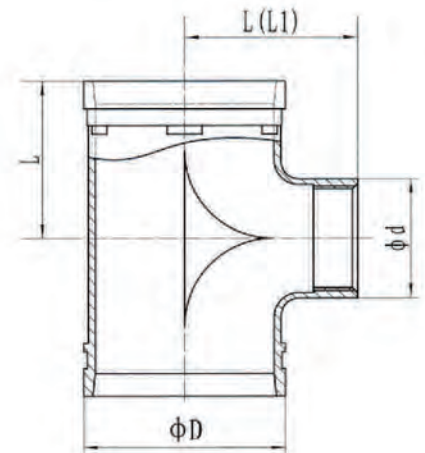

Grooved Cross XGQT05

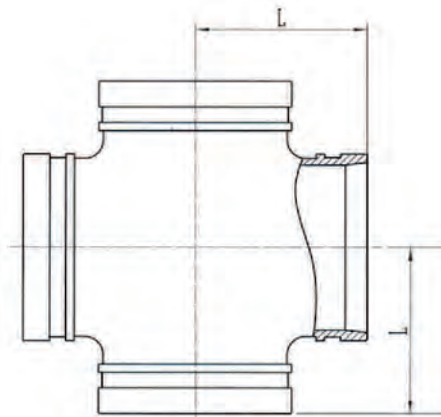

Nominal Size mm/in	Pipe O.D mm/in	Dimensions		Working Pressure (psi)
		L (mm)		
		Short		
50	60.3	70		300
2	2.375	70		
65	73	76		
2 1/2	2.875	76		
65	76.1	76		
2 1/2	3	86		
80	88.9	86		
3	3.5	102		
100	108	102		
4	4.25	102		
100	114.3	102		
4	4.5	121		
125	133	121		
5	5.25	121		
125	139.7	121		
5	5.5	130		
150	159	130		
6	6.25	130		
150	165.1	130		
6	6.5	140		
150	168.3	140		
6	6.625	174		
200	219.1	174		
8	8.625	215		
250	273	215		
10	10.75	245		
300	323.9	245		
12	12.75	245		

Nominal Size mm/in	Pipe O.D mm/in	Dimensions		Working Pressure (psi)
		L (mm)		
		Standard		
50	60.3	83		300
2	2.375	83		
65	73	95		
2 1/2	2.875	95		
65	76.1	95		
2 1/2	3	108		
80	88.9	108		
3	3.5	127		
100	108	127		
4	4.25	127		
100	114.3	127		
4	4.5	140		
125	133	140		
5	5.25	140		
125	139.7	140		
5	5.5	165		
150	159	165		
6	6.25	165		
150	165.1	165		
6	6.5	165		
150	168.3	165		
6	6.625	197		
200	219.1	197		
8	8.625	229		
250	273	229		
10	10.75	254		
300	323.9	254		
12	12.75	254		

Nominal Size mm/in	Pipe O.D mm/in	Dimensions				Working pressure (Psi)
		L (mm)		D	d	
		L	L1	mm	mm	
65x32	73x42.4			73	42	300
2 1/2 x 1 1/4	2.875 x 1.669			76	73	
65x40	73x48.3			76	73	
2 1/2 x 1 1/2	2.875 x 1.9			76	73	
65x50	73x60.3			76	73	
2 1/2 x 2	2.875 x 2.375			76	76	
65x32	76.1x42.4			76	76	
2 1/2 x 1/4	3x1.669			76	76	
65x40	76.1x48.3			76	76	
2 1/2 x 1 1/2	3x1.9			76	76	
65x50	76.1x60.3			76	76	
2 1/2 x 2	3x2.375			76	76	
80x32	88.9x42.4			86	89	
3 x 1/4	3.5x1.669			86	89	
80x40	88.9x48.3			86	89	
3 x 1 1/2	3.5x1.9			86	89	
80x50	88.9x60.3			86	89	
3 x 2	3.5x2.375			86	89	
80x65	88.9x76.1			86	89	
3 x 2 1/2	3.5x3			86	89	
100x50	108x60.3			90	98	
4 x 2	4.25x2.375	90	98	108	60	
100x65	108x76.1			90	98	
4 x 2 1/2	4.25x3	90	98	108	76	
100x80	108x88.9			90	98	
4 x 3	4.25x3.5	90	98	108	89	
100x32	114.3x42.4			90	98	
4 x 1 1/4	4.5x1.669			90	98	
100x40	114.3x48.3			90	98	
4 x 1 1/2	4.5x1.9			90	98	
100x50	114.3x60.3			90	98	
4 x 2	4.5x2.375	90	98	114	60	
100x65	114.3x76.1			90	98	
4 x 2 1/2	4.5x3	90	98	114	76	
100x80	114.3x88.9			90	98	
4 x 3	4.5x3.5	90	98	114	89	
125x65	133x76.1			105	133	
5 x 2 1/2	5.25x3			105	133	
125x80	133x88.9			105	133	
5 x 3	5.25x3.5			105	133	
125x100	133x108			105	133	
5 x 4	5.25x4.25			105	133	
125x100	133x114.3			105	133	
5 x 4	5.25x4.5			105	133	
125x50	139.7x60.3			105	140	
5 x 2	5.5x2.375			105	140	
125x65	139.7x76.1			105	140	
5 x 2 1/2	5.5x3			105	140	
125x80	139.7x88.9			105	140	
5 x 3	5.5x3.5			105	140	
125x100	139.7x108			105	140	
5 x 4	5.5x4.25			105	140	
125x100	139.7x114.3			105	140	
5 x 4	5.5x4.5			105	140	
125x50	141.3x60.3			105	141	
5 x 2	5.563x2.375			105	141	
125x65	141.3x73			105	141	
5 x 2 1/2	5.563x2.875			105	141	
125x80	141.3x88.9			105	141	
5 x 3	5.563x3.5			105	141	
125x100	141.3x108			105	141	
5 x 4	5.563x4.25			105	141	

Grooved Reducing Cross XGQT05

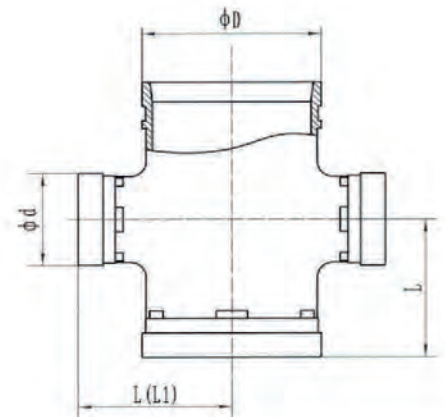

Grooved Reducing Cross XGQT05

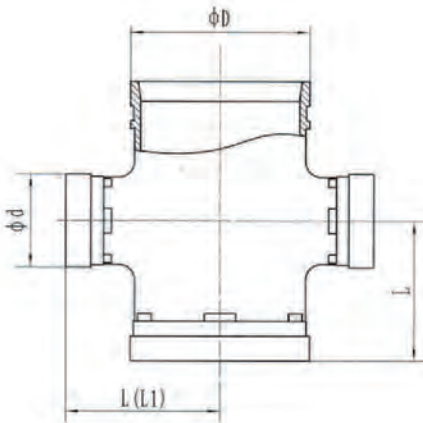

Nominal Size mm/in	Pipe O.D mm/in	Dimensions				Working pressure (Psi)
		L (mm)		D mm	d mm	
		L	L1			
125×100	141.3×114.3	105		141	114	300
5×4	5.563×4.5	105		141	114	
150×65	159×76.1	110	120	159	76	
6×2½	6.25×3	110	120	159	76	
150×80	159×88.9	110	120	159	89	
6×3	6.25×3.5	110	120	159	89	
150×100	159×108	110	120	159	108	
6×4	6.25×4.25	110	120	159	108	
150×100	159×114.3	110	120	159	114	
6×4	6.25×4.5	110	120	159	114	
150×125	159×133	110	120	159	133	
6×5	6.25×5.25	110	120	159	133	
150×50	165.1×60.3	110	120	165	60	
6×2	6.5×2.375	110	120	165	60	
150×65	165.1×76.1	110	120	165	76	
6×2½	6.5×3	110	120	165	76	
150×80	165.1×88.9	110	120	165	89	
6×3	6.5×3.5	110	120	165	89	
150×100	165.1×108	110	120	165	108	
6×4	6.5×4.25	110	120	165	108	
150×100	165.1×114.3	110	120	165	114	
6×4	6.5×4.5	110	120	165	114	
150×125	165.1×133	110	120	165	133	
6×5	6.5×5.25	110	120	165	133	
150×125	165.1×139.7	110	120	165	140	
6×5	6.5×5.5	110	120	165	140	
150×50	168.3×60.3	110	120	168	60	
6×2	6.625×2.375	110	120	168	60	
150×65	168.3×76.1	110	120	168	76	
6×2½	6.625×3	110	120	168	76	
150×80	168.3×88.9	110	120	168	89	
6×3	6.625×3.5	110	120	168	89	
150×100	168.3×108	110	120	168	108	
6×4	6.625×4.25	110	120	168	108	
150×100	168.3×114.3	110	120	168	114	
6×4	6.625×4.5	110	120	168	114	
150×125	168.3×133	110	120	168	133	
6×5	6.625×5.25	110	120	168	133	
150×125	168.3×139.7	110	120	168	140	
6×5	6.625×5.5	110	120	168	140	
200×65	219.1×76.1	146		219	76	
8×2½	8.625×3	146		219	76	
200×80	219.1×88.9	146		219	89	
8×3	8.625×3.5	146		219	89	
200×100	219.1×108	146		219	108	
8×4	8.625×4.25	146		219	108	
200×100	219.1×114.3	146		219	114	
8×4	8.625×4.5	146		219	114	
200×125	219.1×133	146		219	133	
8×5	8.625×5.25	146		219	133	
200×125	219.1×139.7	146		219	140	
8×5	8.625×5.5	146		219	140	
200×150	219.1×159	146		219	159	
8×6	8.625×6.25	146		219	159	
200×150	219.1×165.1	146		219	165	
8×6	8.625×6.5	146		219	165	

Nominal Size mm/in	Pipe O.D mm/in	Dimensions				Working pressure Psi
		L (mm)		D	d	
		L	L1	mm	mm	
50×25	60.3×33.7	70		60	43	230
2×1	2.375×1.327					
50×32	60.3×42.4	70		60	52	
2×1¼	2.375×1.669					
50×40	60.3×48.3	70		60	58	
2×1½	2.375×1.9					
65×25	73.0×33.7	76		73	43	
2½×1	2.875×1.327					
65×32	73.0×42.4	76		73	52	
2½×1¼	2.875×1.669					
65×40	73.0×48.3	76		73	58	
2½×1½	2.875×1.9					
65×50	73.0×60.3	76		73	70	
2½×2	2.875×2.375					
65×25	76.1×33.7	76		76	43	
2½×1	3×1.327					
65×32	76.1×42.4	76		76	52	
2½×1¼	3×1.669					
65×40	76.1×48.3	76		76	58	
2½×1½	3×1.9					
65×50	76.1×60.3	76		76	70	
2½×2	3×2.375					
80×25	88.9×33.7	86		89	43	
3×1	3.5×1.327					
80×32	88.9×42.4	86		89	52	
3×1¼	3.5×1.669					
80×40	88.9×48.3	86		89	58	
3×1½	3.5×1.9					
80×50	88.9×60.3	86		89	70	
3×2	3.5×2.375					
80×65	88.9×76.1	86		89	86	
3×2½	3.5×3					
100×50	108.0×60.3	90	98	108	70	
4×2	4.25×2.375					
100×65	108.0×76.1	90	98	108	86	
4×2½	4.25×3					
100×80	108×88.9	90	98	108	99	
4×3	4.25×3.5					
100×25	114.3×33.7	90	98	114	43	
4×1	4.5×1.327					
100×32	114.3×42.4	90	98	114	52	
4×1¼	4.5×1.669					
100×40	114.3×48.3	90	98	114	58	
4×1½	4.5×1.9					
100×50	114.3×60.3	90	98	114	70	
4×2	4.5×2.375					
100×65	114.3×76.1	90	98	114	86	
4×2½	4.5×3					
100×80	114.3×88.9	90	98	114	99	
4×3	4.5×3.5					
125×40	139.7×48.3	105		140	58	
5×1½	5.5×1.9					
125×50	139.7×Rc2	105		140	70	
5×2	5.5×2.375					
125×65	139.7×76.1	105		140	86	
5×2½	5.5×3					
125×80	139.7×88.9	105		140	99	
5×3	5.5×3.5					
125×100	139.7×114.3	105		140	124	
5×4	5.5×4.5					
125×40	141.3×48.3	105		141	58	
5×1½	5.563×1.9					

Threaded Reducing Cross XGQT05S

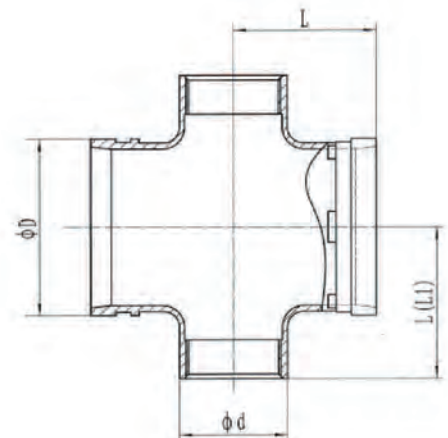

Threaded Reducing Cross XGQT05S

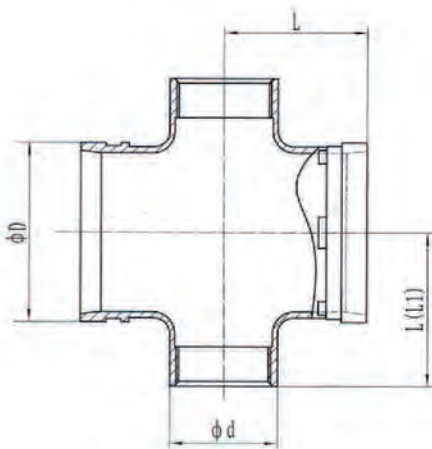

Nominal Size mm/in	Pipe O.D mm/in	Dimensions				Working pressure Psi
		L (mm)		D	d	
		L	L1	mm	mm	
125×50 5×2	141.3×60.3 5.563×2.375	105		141	70	230
125×65 5×2½	141.3×73 5.563×2.875	105		141	86	
125×80 5×3	141.3×88.9 5.563×3.5	105		141	99	
125×100 5×4	141.3×114.3 5.563×4.5	105		141	124	
150×50 6×2	159.0×60.3 6.250×2.375	110	120	159	70	
150×65 6×2½	159.0×76.1 6.25×3	110	120	159	86	
150×80 6×3	159.0×88.9 6.25×3.5	110	120	159	99	
150×100 6×4	159.0×114.3 6.25×4.5	110	120	159	124	
150×40 6×1½	165.1×48.3 6.5×1.9	110	120	165	58	
150×50 6×2	165.1×60.3 6.5×2.375	110	120	165	70	
150×65 6×2½	165.1×76.1 6.5×3	110	120	165	86	
150×80 6×3	165.1×88.9 6.5×3.5	110	120	165	99	
150×100 6×4	165.1×114.3 6.5×4.5	110	120	165	124	
150×40 6×1½	168.3×48.3 6.625×1.9	110	120	168	58	
150×50 6×2	168.3×60.3 6.625×2.375	110	120	168	70	
150×65 6×2½	168.3×76.1 6.625×3	110	120	168	86	
150×80 6×3	168.3×88.9 6.625×3.5	110	120	168	99	
150×100 6×4	168.3×Rc4 6.625×4.5	110	120	168	124	
200×50 8×2	219.1×60.3 8.625×2.375	146		219	70	
200×50 8×2½	219.1×76.1 8.625×3	146		219	86	
200×80 8×3	219.1×88.9 8.625×3.5	146		219	99	
200×100 8×4	219.1×114.3 8.625×4.5	146		219	124	

Nominal Size mm/in	Pipe O.D mm/in	Dimensions			Hole Dimension (Φ-mm)	Bolt/Nut	Working pressure Psi
		A mm	L mm	H mm		No.-size (mm)	
50×25	60.3×33.7	120	64	70	38	3/8×2 (M10×50)	300
2×1	2.375×1.327						
50×32	60.3×42.4	120	72	70	46		
2×1¼	2.375×1.669						
50×40	60.3×48.3	120	72	70	46		
2×1½	2.375×1.9						
65×25	73×33.7	139	64	73	38		
2½×1	2.875×1.327						
65×32	73×42.4	139	72	73	46		
2½×1¼	2.875×1.669						
65×40	73×48.3	139	79	75	53		
2½×1½	2.875×1.9						
65×25	76.1×33.7	139	64	73	38		
2½×1	3×1.327						
65×32	76.1×42.4	139	72	73	46		
2½×1¼	3×1.669						
65×40	76.1×48.3	139	79	75	53		
2½×1½	3×1.9						
80×25	88.9×33.7	155	64	82	38		
3×1	3.5×1.327						
80×32	88.9×42.4	155	72	82	46		
3×1¼	3.5×1.669						
80×40	88.9×48.3	155	79	82	53		
3×1½	3.5×1.9						
80×50	88.9×60.3	155	90	82	64		
3×2	3.5×2.375						
100×50	108×60.3	172	90	92.5	64		
4×2	4.25×2.375						
100×65	108×76.1	172	107	92.5	80		
4×2½	4.25×3						
100×25	114.3×33.7	181	64	95.5	38		
4×1	4.5×1.327						
100×32	114.3×42.4	181	72	95.5	46		
4×1¼	4.5×1.669						
100×40	114.3×48.3	181	79	95.5	53		
4×1½	4.5×1.9						
100×50	114.3×60.3	181	90	95.5	64		
4×2	4.5×2.375						
100×65	114.3×73	181	117	99	70		
4×2½	4.5×2.875						
100×65	114.3×76.1	181	117	99	70		
4×2½	4.5×3						
100×80	114.3×88.9	181	136	99	89		
4×3	4.5×3.5						
125×40	133×48.3	205	90	105.5	53		
5×1½	5.25×1.9						
125×50	133×60.3	205	100	105.5	64		
5×2	5.25×2.375						
125×65	133×76.1	205	117	105.5	80		
5×2½	5.25×3						
125×80	133×88.9	205	129	105.5	92		
5×3	5.25×3.5						
125×40	139.7×48.3	212	90	109	53		
5×1½	5.5×1.9						
125×50	139.7×60.3	212	100	109	64		
5×2	5.5×2.375						
125×65	139.7×76.1	212	117	109	70		
5×2½	5.5×3						
125×80	139.7×88.9	212	129	109	89		
5×3	5.5×3.5						
125×100	139.7×114.3	212	154	113	114		
5×4	5.5×4.5						

Grooved Mechanical Tee XGQT04G

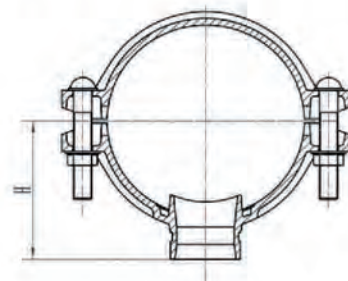
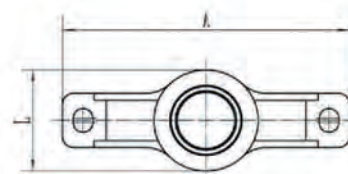

Grooved Mechanical Tee XGQT04G

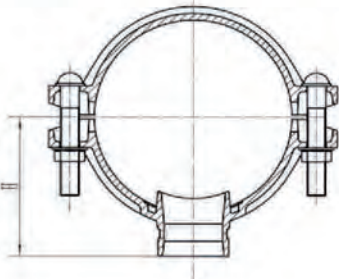
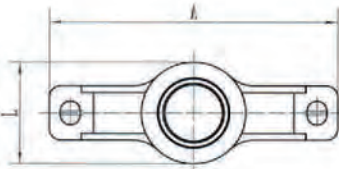

Nominal Size mm/in	Pipe O.D mm/in	Dimensions			Hole Dimension (Φ-mm)	Bolt/Nut No.-size (mm)	Working pressure Psi
		A mm	L mm	H mm			
125×40 5×1½	141.3×48.3 5.563×1.9	212	90	109	53	1/2×3 (M12×75)	300
125×50 5×2	141.3×60.3 5.563×2.375						
125×65 5×2½	141.3×73 5.563×2.875	212	117	113	70		
125×80 5×3	141.3×88.9 5.563×3.5						
150×50 6×2	159×60.3 6.25×2.375	233	100	118	64		
150×65 6×2½	159×76.1 6.25×3						
150×80 6×3	159×88.9 6.25×3.5	233	129	118	92		
150×100 6×4	159×108 6.25×4.25						
150×100 6×4	159×114.3 6.25×4.5	233	153	119.5	111		
150×50 6×2	165.1×60.3 6.5×2.375						
150×65 6×2½	165.1×76.1 6.5×3	248	107	126	80		
150×80 6×3	165.1×88.9 6.5×3.5						
150×100 6×4	165.1×108 6.5×4.25	239	143	122	104		
150×100 6×4	165.1×114.3 6.5×4.5						
150×32 6×1¼	168.3×42.4 6.625×1.669	248	72	121	46		
150×40 6×1½	168.3×48.3 6.625×1.9						
150×50 6×2	168.3×60.3 6.625×2.375	239	100	121	64		
150×65 6×2½	168.3×73 6.625×2.875						
150×65 6×2½	168.3×76.1 6.625×3	248	117	127	70		
150×80 6×3	168.3×88.9 6.625×3.5						
150×100 6×4	168.3×114.3 6.625×4.5	248	162	129	114		
200×50 8×2	219.1×60.3 8.625×2.375						
200×65 8×2½	219.1×73 8.625×2.875	311	117	154	70		
200×65 8×2½	219.1×76.1 8.625×3						
200×80 8×3	219.1×88.9 8.625×3.5	311	136	154	89		
200×100 8×4	219.1×108 8.625×4.25						
200×100 8×4	219.1×114.3 8.625×4.5	311	162	156	114		
200×125 8×5	219.1×133 8.625×5.25						
200×125 8×5	219.1×139.7 8.625×5.5	311	178	149	135		
250×100 10×4	273×114 10.75×4.5						

Nominal Size mm/in	Pipe O.D mm/in	Dimensions			Pipehole Dia (Φ-mm)	Bolt/Nut Size (mm)	Working pressure Psi
		A mm	L mm	H mm			
50×15	60.3×21.3	120	54	50	30	3/8×2 (M10×50)	300
2×1/2	2.375×0.825						
50×20	60.3×26.7	120	54	50	30		
2×3/4	2.375×1.05						
50×25	60.3×33.7	120	64	50	38		
2×1	2.375×1.327						
50×32	60.3×42.4	120	72	55	46		
2×1 1/4	2.375×1.669						
50×40	60.3×48.3	120	72	63	46		
2×1 1/2	2.375×1.9						
65×15	73×21.3	139	54	58	30	3/8×2-1/4 (M10×55)	300
2 1/2×1 1/2	2.375×0.825						
65×20	73×26.7	139	54	58	30		
2 1/2×3/4	2.875×1.05						
65×25	73.0×33.7	139	65	60	38		
2 1/2×1	2.875×1.327						
65×32	73.0×42.4	139	72	60	46		
2 1/2×1 1/4	2.875×1.669						
65×40	73.0×48.3	139	79	60	53		
2 1/2×1 1/2	2.875×1.9						
65×15	76.1×21.3	139	54	58	30		
2 1/2×1 1/2	3×0.825						
65×20	76.1×26.7	139	54	58	30		
2 1/2×3/4	3×1.05						
65×25	76.1×33.7	139	65	60	38		
2 1/2×1	3×1.327						
65×32	76.1×42.4	139	72	60	46		
2 1/2×1 1/4	3×1.669						
65×40	76.1×48.3	139	79	60	53		
2 1/2×1 1/2	3×1.9						
80×15	88.9×21.3	155	59	66.5	30	1/2×2-5/8 (M12×65)	300
3×1/2	3.5×0.825						
80×20	88.9×26.7	155	59	66.5	30		
3×3/4	3.5×1.05						
80×25	88.9×33.7	155	64	67	38		
3×1	3.5×1.327						
80×32	88.9×42.4	155	72	67	46		
3×1 1/4	3.5×1.669						
80×40	88.9×48.3	155	79	67	53		
3×1 1/2	3.5×1.9						
80×50	88.9×60.3	155	90	67	64		
3×2	3.5×2.375						
100×25	108.1×33.7	167	76	76	38		
4×1	4.250×1.327						
100×32	108.0×42.4	167	83	76	46		
4×1 1/4	4.25×1.669						
100×40	108.0×48.3	167	90	76	53		
4×1 1/2	4.25×1.9						
100×50	108.0×60.3	167	100	78	64		
4×2	4.25×2.375						

Threaded Mechanical Tee XGQT04

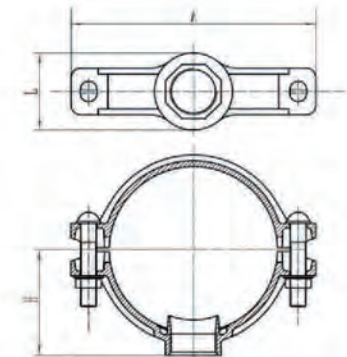

Threaded Mechanical Tee XGQT04

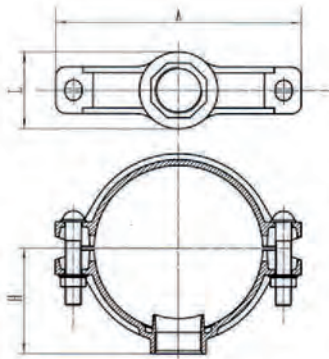

Nominal Size mm/in	Pipe O.D mm/in	Dimensions			Pipehole Dia (Φ-mm)	Bolt/Nut Size (mm)	Working pressure Psi
		A mm	L mm	H mm			
100×65	108.0×76.1	167	117	105	80	1/2×2-5/8 (M12×65)	300
4×2½	4.25×3						
100×25	114.3×33.7	181	64	79	38		
4×1	4.5×1.327						
100×32	114.3×42.4	181	72	79	46		
4×1¼	4.5×1.669						
100×40	114.3×48.3	181	79	79	53		
4×1½	4.5×1.9						
100×50	114.3×60.3	181	90	79	64		
4×2	4.5×2.375						
100×65	114.3×76.1	181	117	105	70		
4×2½	4.5×3						
100×80	114.3×88.9	181	129	83	89		
4×3	4.5×3.5						
125×25	133.0×33.7	205	76	89	38		
5×1	5.250×1.327						
125×32	133.0×42.4	205	83	89	46		
5×1¼	5.25×1.669						
125×40	133.0×48.3	205	90	89	53		
5×1½	5.25×1.9						
125×50	133.0×60.3	205	100	89	64		
5×2	5.25×2.375						
125×65	133.0×76.1	205	117	92	80		
5×2½	5.25×3						
125×80	133.0×88.9	205	129	94	92		
5×3	5.25×3.5						
125×25	139.7×33.7	212	76	93	38		
5×1	5.5×1.327						
125×32	139.7×42.4	212	83	93	46		
5×1¼	5.5×1.669						
125×40	139.7×48.3	212	90	93	53		
5×1½	5.5×1.9						
125×50	139.7×60.3	212	100	93	64		
5×2	5.5×2.375						
125×65	139.7×76.1	212	117	93	70		
5×2½	5.5×3						
125×80	139.7×88.9	212	129	95	89		
5×3	5.5×3.5						
125×25	141.3×33.7	212	76	93	38		
5×1	5.563×1.327						
125×32	141.3×42.4	212	83	93	46		
5×1¼	5.563×1.669						
125×40	141.3×48.3	212	90	93	53		
5×1½	5.563×1.9						
125×50	141.3×60.3	212	100	93	64		
5×2	5.563×2.375						
125×65	141.3×76.1	212	117	115	70		
5×2½	5.563×3						
125×80	141.3×88.9	212	136	118	89		
5×3	5.563×3.5						

Nominal Size mm/in	Pipe O.D mm/in	Dimensions			Pipehole Dia (Φ-mm)	Bolt/Nut Size (mm)	Working pressure Psi	
		A mm	L mm	H mm				
150×25 6×1	159×33.7 6.250×1.327	233	76	101.5	38	9/16×3 (M14×75)	300	
150×32 6×1¼	159.0×42.4 6.250×1.669							
150×40 6×1½	159.0×48.3 6.250×1.9							
150×50 6×2	159.0×60.3 6.250×2.375	233	100	101.5	64			
150×65 6×2½	159.0×76.1 6.250×3							
150×80 6×3	159.0×88.9 6.250×3.5	233	129	105.5	80			5/8×3-1/3 (M16×85)
150×100 6×4	159.0×114.3 6.250×4.5							
150×25 6×1	165.1×33.7 6.5×1.327	248	64	106	38			
150×32 6×1¼	165.1×42.4 6.5×1.669							
150×40 6×1½	165.1×48.3 6.5×1.9	248	79	106	53			
150×50 6×2	165.1×60.3 6.5×2.375							
150×65 6×2½	165.1×76.1 6.5×3	248	107	106	80			
150×80 6×3	165.1×88.9 6.5×3.5							
150×100 6×4	165.1×114.3 6.5×4.5	239	157	110	118			
150×25 6×1	168.3×33.7 6.625×1.327	248	64	106	38	5/8×3-1/3 (M16×85)		
150×32 6×1¼	168.3×42.4 6.625×1.669							
150×40 6×1½	168.3×48.3 6.625×1.9	248	79	106	53			
150×50 6×2	168.3×60.3 6.625×2.375							
150×65 6×2½	168.3×76.1 6.625×3	248	117	128	70			
150×80 6×3	168.3×88.9 6.625×3.5							
150×100 6×4	168.3×Rc4 6.625×4.5	248	162	139.5	114			
200×25 8×1	219.1×33.7 8.625×1.327	311	76	131	38			
200×32 8×1¼	219.1×42.4 8.625×1.669							
200×40 8×1½	219.1×48.3 8.625×1.9	311	90	134	53			
200×50 8×2	219.1×60.3 8.625×2.375							
200×65 8×2½	219.1×76.1 8.625×3	311	117	156	70			
200×80 8×3	219.1×88.9 8.625×3.5							
200×100 8×4	219.1×114.3 8.625×4.5	311	162	167	114			
250×65 10×2½	273.0×76.1 10.75×3	379	117	159	80	3/4×3-1/2 (M20×90)		
250×80 10×3	273.0×88.9 10.75×3.5							
		379	129	162	92			

Threaded Mechanical Tee XGQT04

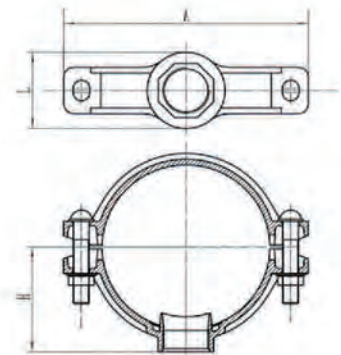

Grooved Mechanical Cross XGQT04G

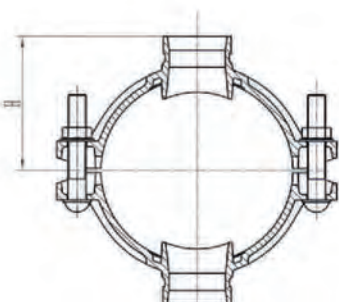
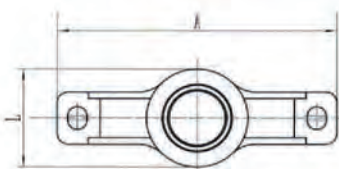

Nominal Size mm/in	Pipe O.D mm/in	Dimensions			Hole Dimension (Φ-mm)	Bolt/Nut No.-size (mm)	Working pressure (psi)
		A mm	L mm	H mm			
65×25 2½×1	76.1×33.7 3×1.327	139	72	73	38	3/8×2-1/8 (M10×55)	300
65×32 2½×1¼	76.1×42.4 3×1.669						
65×40 2½×1½	76.1×48.3 3×1.9	139	90	75	53		
80×32 3×1¼	88.9×42.4 3.5×1.669						
80×40 3×1½	88.9×48.3 3.5×1.9	155	83	82	46		
80×50 3×2	88.9×60.3 3.5×2.375						
100×50 4×2	108×60.3 4.25×2.375	167	100	92.5	64		
100×25 4×1	114.3×33.7 4.5×1.327						
100×32 4×1¼	114.3×42.4 4.5×1.669	181	72	95.5	38		
100×40 4×1½	114.3×48.3 4.5×1.9						
100×50 4×2	114.3×60.3 4.5×2.375	181	83	95.5	46		
125×40 5×1½	139.7×48.3 5.5×1.9						
125×50 5×2	139.7×60.3 5.5×2.375	212	90	109	53		
125×65 5×2½	139.7×76.1 5.5×3						
125×40 5×1½	141.3×48.3 5.563×1.9	212	117	109	64		
125×50 5×2	141.3×60.3 5.563×2.375						
125×65 5×2½	141.3×73 5.563×2.875	212	90	109	53		
150×50 6×2	159×60.3 6.25×2.375						
150×65 6×2½	159×76.1 6.25×3	233	117	118	80		
150×80 6×3	159×88.9 6.25×3.5						
150×50 6×2	165.1×60.3 6.5×2.375	233	129	118	92		
150×65 6×2½	165.1×76.1 6.5×3						
150×80 6×3	165.1×88.9 6.5×3.5	239	100	121	64		
150×65 6×2½	165.1×76.1 6.625×3						
150×80 6×3	165.1×88.9 6.625×3.5	248	107	126	80		
150×50 6×2	168.3×60.3 6.625×2.375						
150×65 6×2½	168.3×76.1 6.625×3	248	117	127	70		
150×80 6×3	168.3×88.9 6.625×3.5						
200×50 8×2	219.1×60.3 8.625×2.375	311	100	147.5	64		
200×65 8×2½	219.1×76.1 8.625×3						
200×80 8×3	219.1×88.9 8.625×3.5	311	117	147.5	70		
200×100 8×4	219.1×108 8.625×4.25						
200×100 8×4	219.1×114.3 8.625×4.5	311	129	147.5	89		
		311	143	148.5	104		
		311	153	149	114		

Nominal Size mm/in	Pipe O.D mm/in	Dimensions			Hole Dimension (Φ-mm)	Bolt/Nut No.-size (mm)	Working pressure (Mpa)
		A mm	L mm	H mm			
65×25	76.1×33.7	139	76	60	38	3/8×2-1/8 (M10×55)	230
2 1/2×1	3×1.327						
65×32	76.1×42.4	139	83	60	46		
2 1/2×1 1/4	3×1.669						
80×25	88.9×33.7	152	76	63.5	38		
3×1	3.5×1.327						
80×32	88.9×42.4	152	83	64.5	46		
3×1 1/4	3.5×1.669						
80×40	88.9×48.3	152	90	65.5	53		
3×1 1/2	3.5×1.9						
100×25	108.1×33.7	167	76	76	38		
4×1	4.25×1.327						
100×32	108.0×42.4	167	83	76	46		
4×1 1/4	4.25×1.669						
100×40	108.0×48.3	167	90	76	53		
4×1 1/2	4.25×1.9						
100×50	108.0×60.3	167	100	78	64		
4×2	4.25×2.375						
100×25	114.3×33.7	181	76	79	38		
4×1	4.5×1.327						
100×32	114.3×42.4	181	83	79	46		
4×1 1/4	4.5×1.669						
100×40	114.3×48.3	181	90	79	53		
4×1 1/2	4.5×1.9						
100×50	114.3×60.3	181	100	83	64		
4×2	4.5×2.375						
125×25	139.7×33.7	212	76	93	38		
5×1	5.5×1.327						
125×32	139.7×42.4	212	83	93	46		
5×1 1/4	5.5×1.669						
125×40	139.7×48.3	212	90	93	53		
5×1 1/2	5.5×1.9						
125×50	139.7×60.3	212	100	93	64		
5×2	5.5×2.375						
125×65	139.7×76.1	212	117	93	70		
5×2 1/2	5.5×3						
150×25	165.1×33.7	248	64	106	38		
6×1	6.5×1.327						
150×32	165.1×42.4	248	72	106	46		
6×1 1/4	6.5×1.669						
150×40	165.1×48.3	239	79	106	53		
6×1 1/2	6.5×1.9						
150×50	165.1×60.3	248	90	106	64		
6×2	6.5×2.375						
150×65	165.1×76.1	248	107	106	80		
6×2 1/2	6.5×3						
150×80	165.1×88.9	248	118	108	92		
6×3	6.5×3.5						
150×25	168.3×33.7	248	64	106	38		
6×1	6.625×1.327						
150×32	168.3×42.4	248	72	106	46		
6×1 1/4	6.625×1.669						

Threaded Mechanical Cross XGQT04

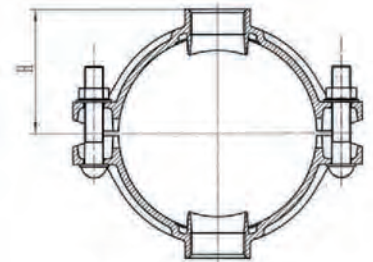
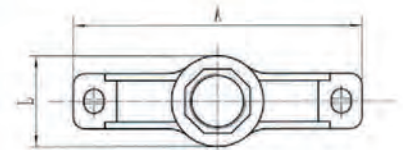

Threaded Mechanical Cross XGQT04

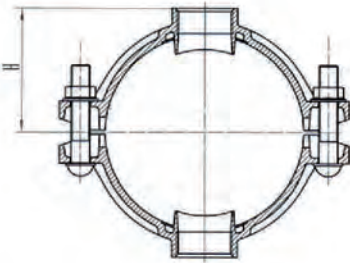
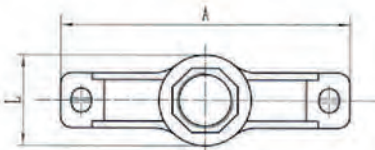

Nominal Size mm/in	Pipe O.D mm/in	Dimensions			Hole Dimension (Φ-mm)	Bolt/Nut No.-size (mm)	Working pressure (Mpa)
		A mm	L mm	H mm			
150×40 6×1½	168.3×48.3 6.625×1.9	248	79	106	53	9/16×3-1/3 (M14×85)	230
150×50 6×2	168.3×60.3 6.625×2.375						
150×65 6×2½	168.3×76.1 6.625×3	248	117	128	70		
150×80 6×3	168.3×88.9 6.625×3.5						
200×25 8×1	219.1×33.7 8.625×1.327	311	76	131	38		
200×32 8×1¼	219.1×42.4 8.625×1.669						
200×40 8×1½	219.1×48.3 8.625×1.9	311	83	134	46		
200×50 8×2	219.1×60.3 8.625×2.375						
200×65 8×2½	219.1×76.1 8.625×3	311	117	156	70		
200×80 8×3	219.1×88.9 8.625×3.5						
200×100 8×4	219.1×114.3 8.625×4.5	311	162	167	114		

90° Reducing Elbow XGQT014

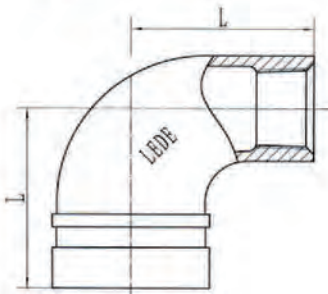

Nominal Size (mm/in)	Dimensions L (mm)	Working Pressure (psi)
32×15 1¼×½	61	300
32×20 1¼×¾		
32×25 1¼×1		
40×15 1½×½		
40×20 1½×¾	64	
40×25 1½×1		
50×15 2×½		
50×20 2×¾		
50×25 2×1	70	
65×15 2½×½		
65×20 2½×¾		
65×25 2½×1		

Nominal Size mm/in	Pipe O.D mm/in	Dimensions			Bolt inch/mm	Working pressure Psi	
		A mm	L mm	H mm			
25x15 1x1/2	24.00 0.95	46	74	44	5/16x1-3/4 (M8x44)	300	
25x20 1x3/4	24.00 0.95						
32x15 1 1/4x1/2	30.00 1.18	53	89	56	3/8x3-1/8 (M10x78)		
32x20 1 1/4x3/4	30.00 1.18						
32x25 1 1/4x1	30.00 1.18	56	89	56			
40x15 1 1/2x1/2	30.00 1.18						
40x20 1 1/2x3/4	30.00 1.18	55	89	56			
40x25 1 1/2x1	30.00 1.18						
50x15 2x1/2	30.00 1.18	64	98	56			3/8x3-3/5 (M10x92)
50x20 2x3/4	30.00 1.18						
50x25 2x1	30.00 1.18	67	98	56			
65x15 2 1/2x1/2	30.00 1.18						
65x20 2 1/2x3/4	30.00 1.18	69	111	56	3/8x4-1/4 (M10x108)		
65x25 2 1/2x1	30.00 1.18						
80x25 3x1	30.00 1.18	80.5	128	56			3/8x4-5/16 (M10x135)

U-Bolt Mechanical Tee 041

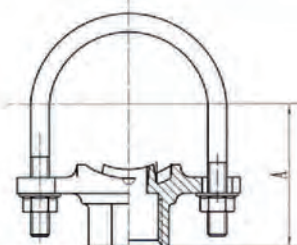
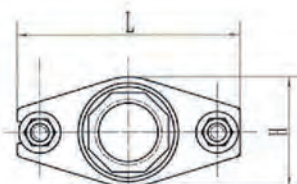

Nominal Size mm/in	Pipe O.D mm/in	Dimensions			Bolt inch/mm	Working pressure Psi	
		A mm	L mm	H mm			
25x15 1x1/2	24.00 0.95	93	48	28	3/8x1-1/2 (M10x40)	300	
32x15 1 1/4x1/2	30.00 1.18						
32x20 1 1/4x3/4	30.00 1.18	98	65	45			
32x25 1 1/4x1	30.00 1.18						
40x15 1 1/2x1/2	30.00 1.18	105.6	65	48			
40x20 1 1/2x3/4	30.00 1.18						
40x25 1 1/2x1	30.00 1.18	105.6	65	57			
50x15 2x1/2	30.00 1.18						
50x20 2x3/4	30.00 1.18	120	56	54			3/8x2-1/8 (M10x55)
65x15 2 1/2x1/2	30.00 1.18						
65x20 2 1/2x3/4	30.00 1.18	139	56	61			

Small Threaded Mechanical Tee L922

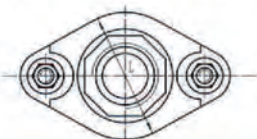
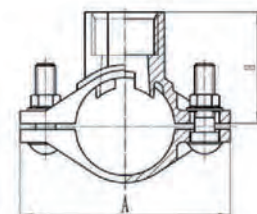

Grooved Reducer XGQT07

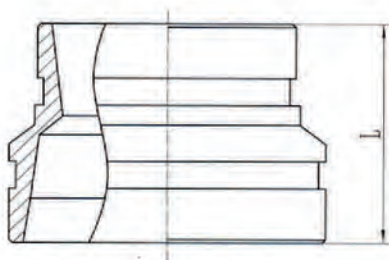

Nominal Size mm/in	Pipe O.D mm/in	Dimensions	Working pressure (Psi)
		L (mm)	
40×32	48.3×42.4	64	300
1½×1¼	1.9×1.669		
50×32	60.3×42.4	64	
2×1¼	2.375×1.669		
50×40	60.3×48.3	64	
2×1½	2.375×1.9		
65×32	73×42.4	64	
2½×1¼	2.875×1.669		
65×40	73×48.3	64	
2½×1½	2.875×1.9		
65×50	73×60.3	64	
2½×2	2.875×2.375		
65×40	76.1×48.3	64	
2½×1½	3×1.9		
65×50	76.1×60.3	64	
2½×2	3×2.375		
80×32	88.9×42.4	64	
3×1¼	3.5×1.669		
80×40	88.9×48.3	64	
3×1½	3.5×1.9		
80×50	88.9×60.3	64	
3×2	3.5×2.375		
80×65	88.9×73	64	
3×2½	3.5×2.875		
80×65	88.9×76.1	64	
3×2½	3.5×3		
100×50	108×60.3	76	
4×2	4.25×2.375		
100×65	108×73	76	
4×2½	4.25×2.875		
100×65	108×76.1	76	
4×2½	4.25×3		
100×80	108×88.9	76	
4×3	4.25×3.5		
100×32	114.3×42.4	76	
4×1¼	4.5×1.669		
100×40	114.3×48.3	76	
4×1½	4.5×1.9		
100×50	114.3×60.3	76	
4×2	4.5×2.375		
100×65	114.3×73	76	
4×2½	4.5×2.875		
100×65	114.3×76.1	76	
4×2½	4.5×3		
100×80	114.3×88.9	76	
4×3	4.5×3.5		
125×50	133×60.3	85	
5×2	5.25×2.375		
125×65	133×73	85	
5×2½	5.25×2.875		
125×65	133×76.1	85	
5×2½	5.25×3		
125×80	133×88.9	85	
5×3	5.25×3.5		
125×100	133×108	85	
5×4	5.25×4.25		
125×100	133×114.3	85	
5×4	5.25×4.5		
125×50	139.7×60.3	85	
5×2	5.5×2.375		
125×65	139.7×73	85	
5×2½	5.5×2.875		

Grooved Reducer XGQT07



Nominal Size mm/in	Pipe O.D mm/in	Dimensions	Working pressure (Psi)
		L (mm)	
125x65	139.7x76.1	85	300
5x2 1/2	5.5x3		
125x80	139.7x88.9	85	
5x3	5.5x3.5		
125x100	139.7x108	85	
5x4	5.5x4.25		
125x100	139.7x114.3	85	
5x4	5.5x4.5		
125x50	141.3x60.3	85	
5x2	5.563x2.375		
125x65	141.3x73	85	
5x2 1/2	5.563x2.875		
125x65	141.3x76.1	85	
5x2 1/2	5.563x3		
125x80	141.3x88.9	85	
5x3	5.563x3.5		
125x100	141.3x114.3	85	
5x4	5.563x4.5		
150x50	159x60.3	85	
6x2	6.25x2.375		
150x65	159x73	85	
6x2 1/2	6.25x2.875		
150x65	159x76.1	85	
6x2 1/2	6.25x3		
150x80	159x88.9	85	
6x3	6.25x3.5		
150x100	159x108	85	
6x4	6.25x4.25		
150x100	159x114.3	85	
6x4	6.25x4.5		
150x125	159x133	85	
6x5	6.25x5.25		
150x125	159x139.7	85	
6x5	6.25x5.5		
150x50	165.1x60.3	85	
6x2	6.5x2.375		
150x65	165.1x73	85	
6x2 1/2	6.5x2.875		
150x65	165.1x76.1	85	
6x2 1/2	6.5x3		
150x80	165.1x88.9	85	
6x3	6.5x3.5		
150x100	165.1x108	85	
6x4	6.5x4.25		
150x100	165.1x114.3	85	
6x4	6.5x4.5		
150x125	165.1x133	85	
6x5	6.5x5.25		
150x125	165.1x139.7	85	
6x5	6.5x5.5		
150x50	168.3x60.3	85	
6x2	6.63x2.375		
150x65	168.3x73	85	
6x2 1/2	6.625x2.875		
150x65	168.3x76.1	85	
6x2 1/2	6.625x2.375		
150x80	168.3x88.9	85	
6x3	6.625x3.5		
150x100	168.3x114.3	85	
6x4	6.625x4.5		
150x125	168.3x139.7	85	
6x5	6.625x5.5		

Nominal Size mm/in	Pipe O.D mm/in	Dimensions	Working pressure (Psi)
		L (mm)	
200x65	219.1x76.1	85	300
8x2 1/2	8.63x3		
200x80	219.1x88.9	85	
8x3	8.625x3.5		
200x100	219.1x108	85	
8x4	8.625x4.25		
200x100	219.1x114.3	85	
8x4	8.625x4.5		
200x125	219.1x139.7	85	
8x5	8.625x5.5		
200x150	219.1x159	85	
8x6	8.625x6.25		
200x150	219.1x165.1	85	
8x6	8.63x6.5		
200x150	219.1x168.3	85	
8x6	8.625x6.63		
250x100	273x108	90	
10x4	10.75x4.25		
250x100	273x114.3	90	
10x4	10.75x4.5		
250x125	273x133	90	
10x5	10.75x5.25		
250x125	273x139.7	90	
10x5	10.75x5.5		
250x150	273x159	90	
10x6	10.75x6.25		
250x150	273x165.1	90	
10x6	10.75x6.5		
250x200	273x219.1	90	
10x8	10.75x8.625		
300x100	323.9x114.3	90	
12x4	12.75x4.5		
300x125	323.9x133	90	
12x5	12.75x5.25		
300x125	323.9x139.7	90	
12x5	12.75x5.5		
300x150	323.9x159	90	
12x6	12.75x6.25		
300x150	323.9x165.1	90	
12x6	12.75x6.625		
300x200	323.9x219.1	90	
12x8	12.75x8.63		
300x250	323.9x273	90	
12x10	12.75x10.75		

Threaded Reducer XGQT07S

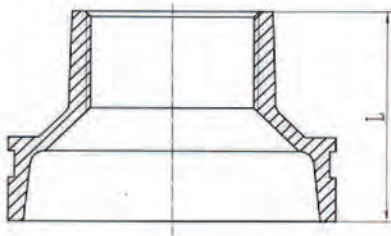

Nominal Size mm/in	Pipe O.D mm/in	Dimensions	Working pressure (Psi)
		L (mm)	
50×25	60.3×33.7	64	230
2×1	2.375×1.327		
50×32	60.3×42.4	64	
2×1¼	2.375×1.669		
50×40	60.3×48.3	64	
2×1½	2.375×1.9		
65×25	73×33.7	64	
2½×1	2.875×1.327		
65×32	73×42.4	64	
2½×1¼	2.875×1.669		
65×40	73×48.3	64	
2½×1½	2.875×1.9		
65×50	73×60.3	64	
2½×2	2.875×2.375		
65×25	76.1×33.7	64	
2½×1	3×1.327		
65×32	76.1×42.4	64	
2½×1¼	3×1.669		
65×40	76.1×48.3	64	
2½×1½	3×1.9		
65×50	76.1×60.3	64	
2½×2	3×2.375		
80×25	88.9×33.7	64	
3×1	3.5×1.327		
80×32	88.9×42.4	64	
3×1¼	3.5×1.669		
80×40	88.9×48.3	64	
3×1½	3.5×1.9		
80×50	88.9×60.3	64	
3×2	3.5×2.375		
80×65	88.9×76.1	64	
3×2½	3.5×3		
100×25	108.0×33.7	76	
4×1	4.25×1.327		
100×32	108.0×42.4	76	
4×1¼	4.25×1.669		
100×40	108.0×48.3	76	
4×1½	4.25×1.9		
100×50	108.0×60.3	76	
4×2	4.25×2.375		
100×65	108.0×76.1	76	
4×2½	4.25×3		
100×80	108×88.9	76	
4×3	4.25×3.5		
100×25	114.3×33.7	76	
4×1	4.5×1.327		
100×32	114.3×42.4	76	
4×1¼	4.5×1.669		
100×40	114.3×48.3	76	
4×1½	4.5×1.9		
100×50	114.3×60.3	76	
4×2	4.5×2.375		
100×65	114.3×76.1	76	
4×2½	4.5×3		
100×80	114.3×88.9	76	
4×3	4.5×3.5		
125×25	133.0×Rc1	85	
5×1	5.25×1.327		
125×32	133.0×42.4	85	
5×1¼	5.25×1.669		
125×40	133.0×48.3	85	
5×1½	5.25×1.9		

Nominal Size mm/in	Pipe O.D mm/in	Dimensions	Working pressure (Psi)
		L (mm)	
125x50	133.0x60.3	85	230
5x2	5.25x2.375		
125x65	133.0x76.1	85	
5x2 1/2	5.25x3		
125x80	133.0x88.9	85	
5x3	5.25x3.5		
125x25	139.7x33.7	85	
5x1	5.5x1.327		
125x32	139.7x42.4	85	
5x1 1/4	5.5x1.669		
125x40	139.7x48.3	85	
5x1 1/2	5.5x1.9		
125x50	139.7x60.3	85	
5x2	5.5x2.375		
125x65	139.7x76.1	85	
5x2 1/2	5.5x3		
125x80	139.7x88.9	85	
5x3	5.5x3.5		
125x100	139.7x114.3	85	
5x4	5.5x4.5		
125x25	141.3x33.7	85	
5x1	5.563x1.327		
125x32	141.3x42.4	85	
5x1 1/4	5.563x1.669		
125x40	141.3x48.3	85	
5x1 1/2	5.563x1.9		
125x50	141.3x60.3	85	
5x2	5.563x2.375		
125x65	141.3x76.1	85	
5x2 1/2	5.563x3		
125x80	141.3x88.9	85	
5x3	5.563x3.5		
125x80	141.3xRc	85	
5x3	5.563x4.5		
150x25	159x33.7	85	
6x1	6.25x1.327		
150x32	159.0x42.4	85	
6x1 1/4	6.25x1.669		
150x40	159.0x48.3	85	
6x1 1/2	6.25x1.9		
150x50	159.0x60.3	85	
6x2	6.25x2.375		
150x65	159.0x76.1	85	
6x2 1/2	6.250x3		
150x80	159.0x88.9	85	
6x3	6.25x3.5		
150x100	159.0x114.3	85	
6x4	6.25x4.5		
150x25	165.1x33.7	85	
6x1	6.5x1.327		
150x32	165.1x42.4	85	
6x1 1/4	6.5x1.669		
150x40	165.1x48.3	85	
6x1 1/2	6.5x1.9		
150x50	165.1x60.3	85	
6x2	6.5x2.375		
150x65	165.1x76.1	85	
6x2 1/2	6.5x3		
150x80	165.1x88.9	85	
6x3	6.5x3.5		
150x100	165.1x114.3	85	
6x4	6.5x4.5		

Threaded Reducer XGQT07S

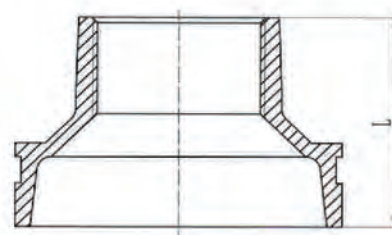

Nominal Size mm/in	Pipe O.D mm/in	Dimensions	Working pressure (Psi)
		L (mm)	
150x25	168.3x33.7	85	230
6x1	6.625x1.327		
150x32	168.3x42.4	85	
6x1 1/4	6.625x1.669		
150x40	168.3x48.3	85	
6x1 1/2	6.625x1.9		
150x50	168.3x60.3	85	
6x2	6.625x2.375		
150x65	168.3x76.1	85	
6x2 1/2	6.625x3		
150x80	168.3x88.9	85	
6x3	6.625x3.5		
150x100	168.3x114.3	85	
6x4	6.625x4.5		
200x25	219.1x33.7	85	
8x1	8.625x1.327		
200x32	219.1x42.4	85	
8x1 1/4	8.625x1.669		
200x40	219.1x48.3	85	
8x1 1/2	8.625x1.9		
200x50	219.1x60.3	85	
8x2	8.625x2.375		
200x65	219.1x76.1	85	
8x2 1/2	8.625x3		
200x80	219.1x88.9	85	
8x3	8.625x3.5		
200x100	219.1x114.3	85	
8x4	8.625x4.5		

Grooved Flange PN16 XGQT09

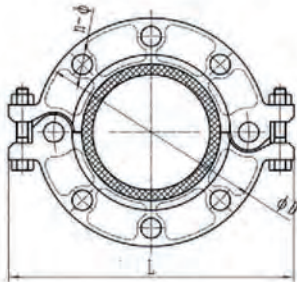

Nominal Size mm/in	Pipe O.D mm/in	Dimensions			Bolt/Nut No.-size (mm)	Working pressure (Psi)
		D mm	L mm	n-φ		
50	60.3	164	210	4-18	3/8×2-3/4 (M10×70)	230
2	2.375					
65	73	182	240	8-18		
2 1/2	2.875					
65	76.1	182	240	8-18		
2 1/2	3					
80	88.9	194	250	8-18		
3	3.5					
100	108	216	266	8-18		
4	4.25					
100	114.3	216	266	8-18		
4	4.5					
125	133	247	300	8-18		
5	5.25					
125	139.7	247	300	8-18		
5	5.5					
125	141.3	247	300	8-18		
5	5.563					
150	159	282	336	8-22		
6	6.25					
150	165.1	282	336	8-22		
6	6.5					
150	168.3	282	336	8-22		
6	6.625					
200	219.1	335	395	12-22		
8	8.625					
250	273	404	470	12-26		
14	10.75					

Grooved Flange ANSI125/150 L991

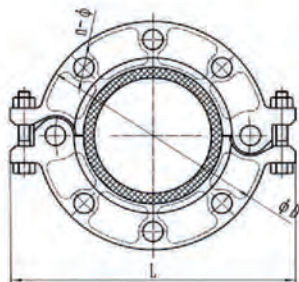

Nominal Size mm/in	Pipe O.D mm/in	Dimensions			Bolt/Nut No.-size (mm)	Working pressure (Psi)
		D mm	L mm	n-φ		
50	60.3	164	210	4-18	3/8×2-3/4 (M10×70)	250
2	2.375					
65	73	176	240	4-18		
2 1/2	2.875					
80	88.9	192	250	4-18		
3	3.5					
100	114.3	224	278	8-18		
4	4.5					
125	141.3	254	310	8-22		
5	5.563					
150	168.3	282	336	8-22		
6	6.625					
200	219.1	343	395	8-22		
8	8.625					
250	273	362	503	12-26		
14	10.75					
300	323.9	432	580	12-26		
16	12.75					

Nominal Size mm/in	Pipe O.D mm/in	Dimensions				Working pressure (Psi)
		ΦD mm	Φd mm	H mm	n- Φ mm	
50	60.30	165	125	60	4-18	230
2	2.38					
65	73.00	185	145	60	4-18	
2 1/2	2.88					
65	76.10	185	145	60	4-18	
2 1/2	3.00					
80	88.90	200	160	60	8-18	
3	3.50					
100	108.00	220	180	60	8-18	
4	4.25					
100	114.30	220	180	60	8-18	
4	4.50					
125	133.00	250	210	65	8-18	
5	5.25					
125	139.70	250	210	65	8-18	
5	5.50					
125	141.30	250	210	65	8-18	
5	5.56					
150	159.00	285	240	65	8-22	
6	6.25					
150	165.10	285	240	65	8-22	
6	6.50					
150	168.30	285	240	65	8-22	
6	6.63					
200	219.10	340	295	70	12-22	
8	8.63					
250	273.00	405	355	72	12-26	
10	10.75					
300	323.90	460	410	72	12-26	
12	12.75					

Flange Adaptor PN16 XGQT08



Nominal Size mm/in	Pipe O.D mm/in	Dimensions (mm)				Working Pressure (psi)
		ΦD	Φd	L	n- Φ	
65	73.00	178	140	75	4-18	250
2 1/2	2.875					
80	88.90	191	153	75	4-18	
3	3.50					
100	114.30	229	191	102	8-18	
4	4.50					
150	168.30	280	241	102	8-22	
6	6.625					

Flange adaptor ANSI125/150 L981

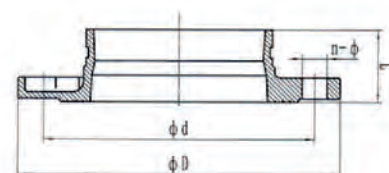

**Grooved Cap
XGQT06**

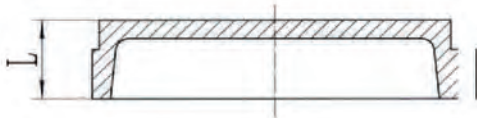

Nominal Size mm/in	Pipe O.D mm/in	Dimensions	Working pressure (Psi)
		L (mm)	
25	33.7	23.8	300
1	1.327		
32	42.4		
1 1/4	1.669	23.8	
40	48.3		
1 1/2	1.9		
50	60.3	23.8	
2	2.375		
65	76.1		
2 1/2	3	23.8	
80	88.9		
3	3.5		
100	108	25.4	
4	4.25		
100	114.3		
4	4.5	25.4	
125	133		
5	5.25		
125	139.7	25.4	
5	"5.5"		
125	141.3		
5	5.563	25.4	
150	159		
5	6.25		
150	165.1	25.4	
6	6.5		
150	168.3		
6	6.625	25.4	
200	219.1		
8	8.625		
250	273	32	
10	10.75		
300	323.9		
12	12.75	32	

**Grooved Eccentric Reducer
XGQT072**



Nominal Size mm/in	Pipe O.D mm/in	Dimensions	Working pressure (Psi)
		L (mm/in)	
100×80	114.3×88.9	80	300
4×3	4.5×3.5		
125×100	139.7×114.3	102	
5×4	5.5×4.5		
150×100	165.1×114.3	102	
6×4	6.5×4.5		
150×125	165.1×139.7	102	
6×5	6.5×5.5		
200×100	219.1×114.3	127	
8×4	8.625×4.5		
200×150	219.1×165.1	127	
8×6	8.625×6.5		
250×150	273×165.1	152	
10×6	10.75×6.5		
250×200	273×219.1	152	
10×8	10.75×8.625		

Nominal Size mm/in	Pipe O.D mm/in	Dimensions	Working pressure (Psi)
		L (mm)	
50×25	60.3×33.7	23.8	300
2×1	2.375×1.327		
50×32	60.3×42.4	23.8	
2×1¼	2.375×1.669		
50×40	60.3×48.3	23.8	
2×1½	2.375×1.9		
65×50	73.0×60.3	23.8	
2½×2	2.875×2.375		
65×25	76.1×33.7	23.8	
2½×1	3×1.327		
65×32	76.1×42.4	23.8	
2½×1¼	3×1.669		
65×40	76.1×48.3	23.8	
2½×1½	3×1.9		
65×50	76.1×60.3	23.8	
2½×2	3×2.375		
80×25	88.9×33.7	23.8	
3×1	3.5×1.327		
80×32	88.9×42.4	23.8	
3×1¼	3.5×1.669		
80×40	88.9×48.3	23.8	
3×1½	3.5×1.9		
80×50	88.9×60.3	23.8	
3×2	3.5×2.375		
100×40	114.3×48.3	25.4	
4×1½	4.5×1.9		
100×50	114.3×60.3	25.4	
4×2	4.5×2.375		
125×50	139.7×60.3	25.4	
5×2	5.5×2.375		
125×50	141.3×60.3	25.4	
5×2	5.563×2.375		
150×50	165.1×60.3	25.4	
6×2	6.5×2.375		
150×40	168.3×48.3	25.4	
6×1½	6.63×1.9		
150×50	168.3×60.3	25.4	
6×2	6.63×2.375		
200×50	219.1×60.3	28	
8×2	8.625×2.375		

Cap with Eccentric hole XGQT061

